

Chains & sprockets	Wear strips	<b>Side guide brackets &amp; accessories</b>	Levelers	Engineering manual
Modular belts & sprockets	Chain & belt return systems	Frame & structure supports	Bearing supports	
Curves & tracks	Side guide solutions	Miscellaneous products	Equipment	

## 5 3 5 1 0 a

## INDEX SIDE GUIDE BRACKETS

[www.SystemPlastSmartGuide.com](http://www.SystemPlastSmartGuide.com)

SIDE GUIDE BRACKETS - FIXED TOP					
TYPE 1	TYPE 2	A		B	PAGE CODE
		TYPE 1	TYPE 2		
		35	-	31	<b>5 3 5 5 5 a</b>
		-	61	38,5	<b>5 3 5 6 0 a</b>
		65	-	30	<b>5 3 5 5 5 a</b>
		66	-	30,5	<b>5 3 5 1 5 a</b>
		-	78,5	30	<b>5 3 5 5 5 a</b>
		-	89	38,5	<b>5 3 5 6 0 a</b>

**ECCENTRIC LEVELER**

**5 3 5 5 5 a**

**SIDE GUIDE BRACKETS STAINLESS STEEL**

**5 3 5 6 5 a**

SIDE GUIDE BRACKETS - SWIVEL TOP					
TYPE 1	TYPE 2	A		B	PAGE CODE
		TYPE 1	TYPE 2		
		69	-	31	<b>5 3 5 2 5 a</b>
		77	70	43	<b>5 3 5 3 5 a</b>
		-	69	44	<b>5 3 5 4 5 a</b>

**MOUNTING TOP**

**5 3 5 8 5 a**

**LATERAL BRACKETS STAINLESS STEEL**

**5 3 5 7 0 a**

**ANGLE BRACKETS THERMOPLASTIC**

**5 3 5 7 5 a**

**ANGLE BRACKETS STAINLESS STEEL**

**5 3 5 8 0 a**

**SPEEDSET™ GUIDE RAIL ADJUSTMENT**

**5 3 5 9 5 a**

**DRIP TRAY BRACKETS**

**5 3 6 0 0 a**

**PHOTOCELL CLAMP ASSEMBLY**

**5 3 6 0 5 a**

**CROSS BLOCKS**

**5 3 6 1 0 a**

**T CLAMPS**

**5 3 6 2 5 a**

**QUICK RELEASE**

**5 3 6 3 0 a**

**CLAMP FOR PHOTOCELLS**

**5 3 6 3 5 a**

**CROSS BLOCK**

**5 3 6 4 5 a**



Information about this product is only available on our Smart Guide® website.

Chains & sprockets	Wear strips	Side guide brackets & accessories	Levelers	Engineering manual
Modular belts & sprockets	Chain & belt return systems	Frame & structure supports	Bearing supports	
Curves & tracks	Side guide solutions	Miscellaneous products	Equipment	

## 53515a

## SIDE GUIDE BRACKETS – FIXED TOP

www.SystemPlastSmartGuide.com

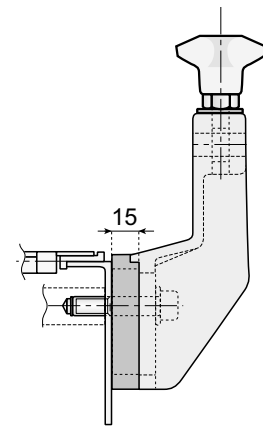
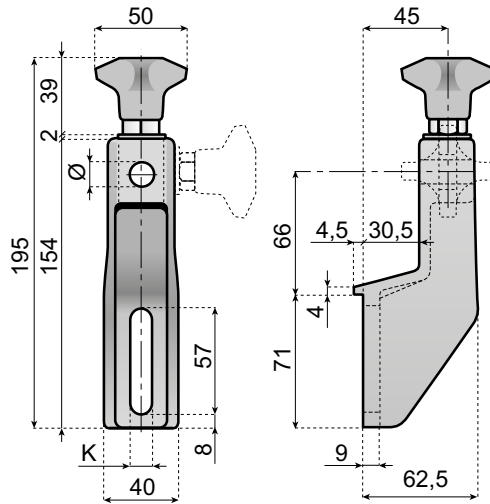

MATERIAL	K mm	Ø 12	Ø 14	
		ITEM DESCRIPTION		
PA-FG	9	BKF-66W31L-90P12	BKF-66W31L-90P14	50
	10,5	BKF-66W31L-105P12	BKF-66W31L-105P14	

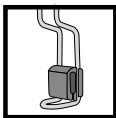

Suitable for drip tray brackets, go to:

**53600a**



To see other types of this bracket go to:

**53515b**

### BRACKET WITH EYEBOLT AND KNOB

**Material:** reinforced polyamide, eyebolt and washer in stainless steel AISI 304, knob in polyamide with nickel plated brass insert.

**Note:** max recommended tightening torque 4 Kgm.

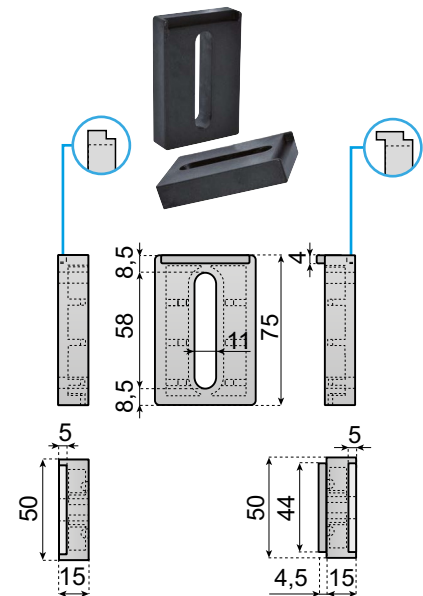

### SPACER FOR BRACKET

TYPE	MATERIAL	ITEM DESCRIPTION	
Without lip	PA-FG	SP-7550T15	50
With lip		SP-7550T15L	50

Chains & sprockets	Wear strips	Side guide brackets & accessories	Levelers	Engineering manual
Modular belts & sprockets	Chain & belt return systems	Frame & structure supports	Bearing supports	
Curves & tracks	Side guide solutions	Miscellaneous products	Equipment	



## 5 3 5 1 5 b

## SIDE GUIDE BRACKETS - FIXED TOP

www.SystemPlastSmartGuide.com



**Material:** reinforced polyamide, eyebolt and washer in stainless steel AISI 304, knob in polyamide with nickel plated brass insert.

**Note:** max recommended tightening torque 4 Kg.

### VERSION WITH PLASTIC KNOB

SLOT K	Ø 12	Ø 14	
	ITEM DESCRIPTION		
9	BKF-66W31L-90P12E	BKF-66W31L-90P14E	50
10,5	BKF-66W31L-105P12E	BKF-66W31L-105P14E	50

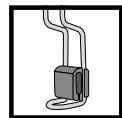

Suitable for drip tray brackets go to:

**5 3 6 0 0 a**

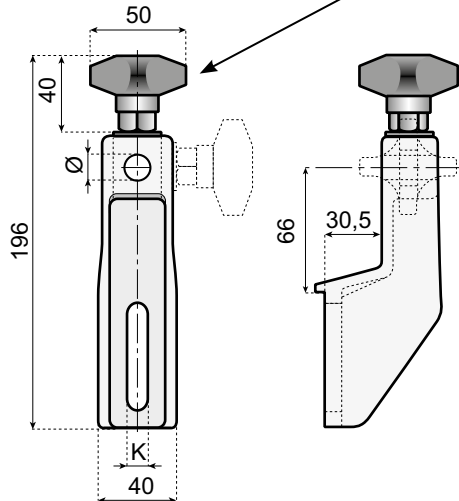

### VERSION WITH HIGH KNOB

SLOT K	Ø 12	Ø 14	
	ITEM DESCRIPTION		
9	BKF-66W31L-90P12H	BKF-66W31L-90P14H	50
10,5	BKF-66W31L-105P12H	BKF-66W31L-105P14H	50

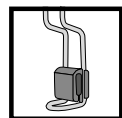

Suitable for drip tray brackets go to:

**5 3 6 0 0 a**

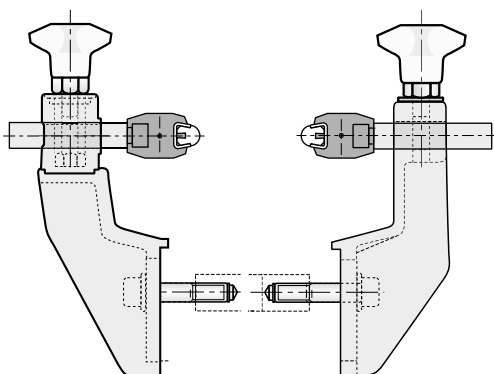
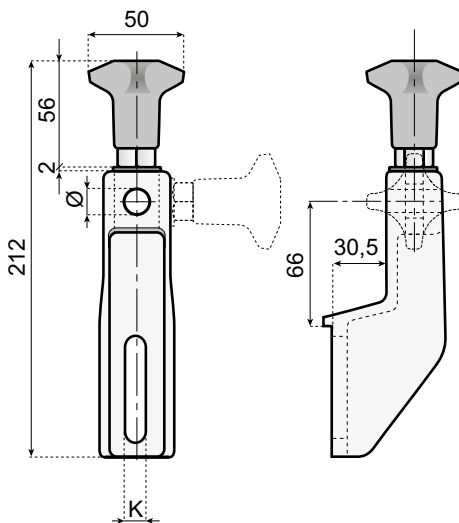

This bracket is suitable for use in combination with brackets with rotating top.

**5 3 5 2 5 a**



For other type of brackets, go to:

**5 3 5 1 5 a**



For spacer for brackets go to:

**5 3 5 1 5 a**

Chains & sprockets	Wear strips	Side guide brackets & accessories	Levelers	Engineering manual
Modular belts & sprockets	Chain & belt return systems	Frame & structure supports	Bearing supports	
Curves & tracks	Side guide solutions	Miscellaneous products	Equipment	

## 5 3 5 2 5 a

## SIDE GUIDE BRACKETS - SWIVEL TOP-LOW VERSION

www.SystemPlastSmartGuide.com

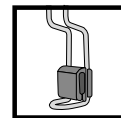
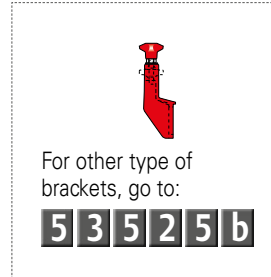
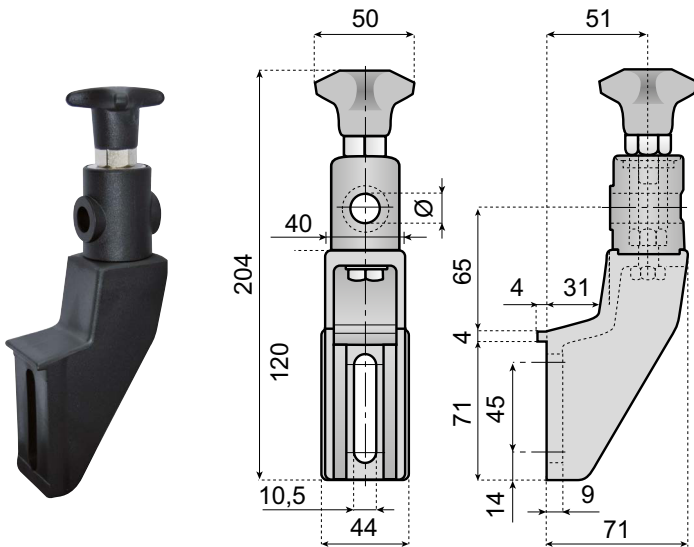

Suitable for drip tray brackets, go to:

5 3 6 0 0 a

PLASTIC				STAINLESS STEEL AISI 304		
Ø 12	Ø 14	Ø 16	Ø 20	Ø 12	Ø 14	Ø 16
<b>ITEM DESCRIPTION</b>						
BKR-69W31LP-P12	BKR-69W31LP-P14	BKR-69W31LP-P16	* BKR-69W31LP-P20	BKR-69W31LS-P12	BKR-69W31LS-P14	BKR-69W31LS-P16

\* Suitable with Speedset™ adjustment: 5 3 5 9 5 a

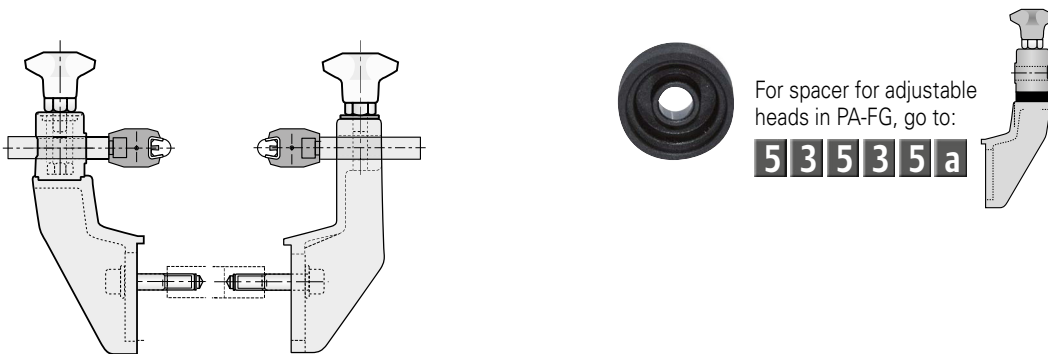

For spacer for adjustable heads in PA-FG, go to:

5 3 5 3 5 a

This bracket is suitable for use in combination with brackets with fixed top.

5 3 5 1 5 a

### Adjustable bracket

**Material:** reinforced polyamide, eyebolt and washer in stainless steel AISI 304, knob in polyamide with nickel plated brass insert.

**Note:** max recommended tightening torque 4 Kgm.



For spacer for brackets go to:

5 3 5 1 5 a

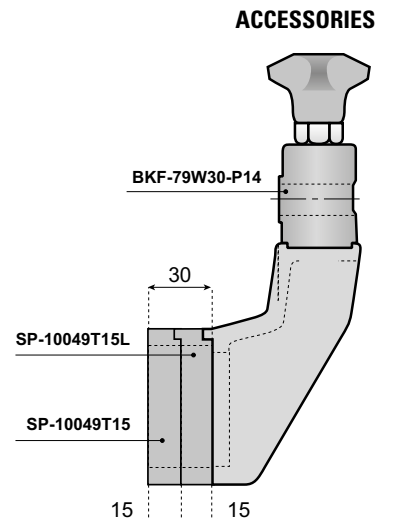

Chains & sprockets	Wear strips	Side guide brackets & accessories	Levelers	Engineering manual
Modular belts & sprockets	Chain & belt return systems	Frame & structure supports	Bearing supports	
Curves & tracks	Side guide solutions	Miscellaneous products	Equipment	

## 5 3 5 2 5 b

## SIDE GUIDE BRACKETS - SWIVEL TOP LOW VERSION

www.SystemPlastSmartGuide.com

**Material:** reinforced polyamide, eyebolt and washer in stainless steel AISI 304, knob in polyamide with nickel plated brass insert.

**Note:** max recommended tightening torque 4 Kgm.

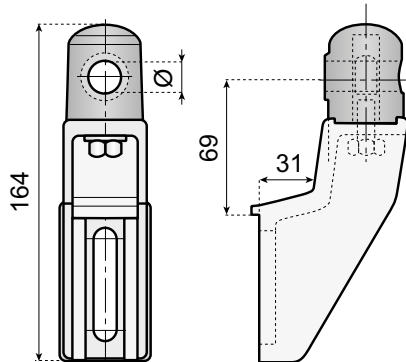

### VERSION WITH CLOSED TOP

	Ø 12	Ø 14	Ø 16	
	ITEM DESCRIPTION			
	BKR-69W31LP-P12B	BKR-69W31LP-P14B	BKR-69W31LP-P16B	50

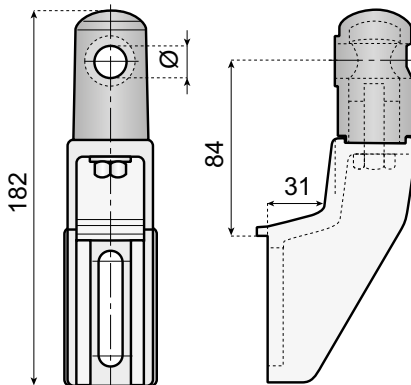

### VERSION WITH CLOSED TOP (HIGH)

	Ø 12	
	ITEM DESCRIPTION	
	BKR-84W31LP-P12B	50

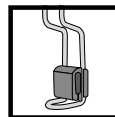

Suitable for drip tray brackets go to:

**5 3 6 0 0 a**

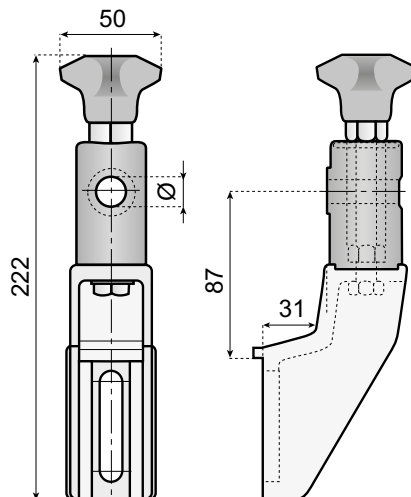

### VERSION WITH HIGH TOP

	Ø 12	Ø 14	Ø 16	
	ITEM DESCRIPTION			
	BKR-87W31LP-P12	BKR-87W31LP-P14	BKR-87W31LP-P16	50

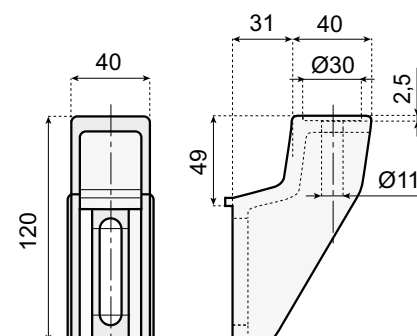

### VERSION WITHOUT TOP

	MATERIAL	ITEM DESCRIPTION	
	PA-FG	BK-49W31L	



For other type of brackets, go to:

**5 3 5 2 5 a**



For spacer for brackets, go to:

**5 3 5 2 5 a**

Chains & sprockets	Wear strips	Side guide brackets & accessories	Levelers	Engineering manual
Modular belts & sprockets	Chain & belt return systems	Frame & structure supports	Bearing supports	
Curves & tracks	Side guide solutions	Miscellaneous products	Equipment	

## 53535a

## SIDE GUIDE BRACKETS - SWIVEL TOP

www.SystemPlastSmartGuide.com

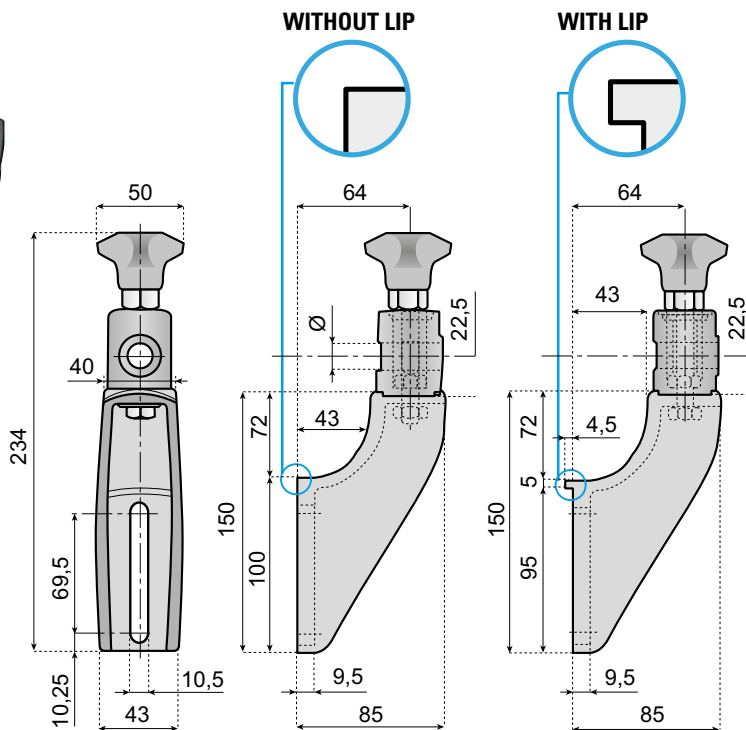

### ACCESSORIES

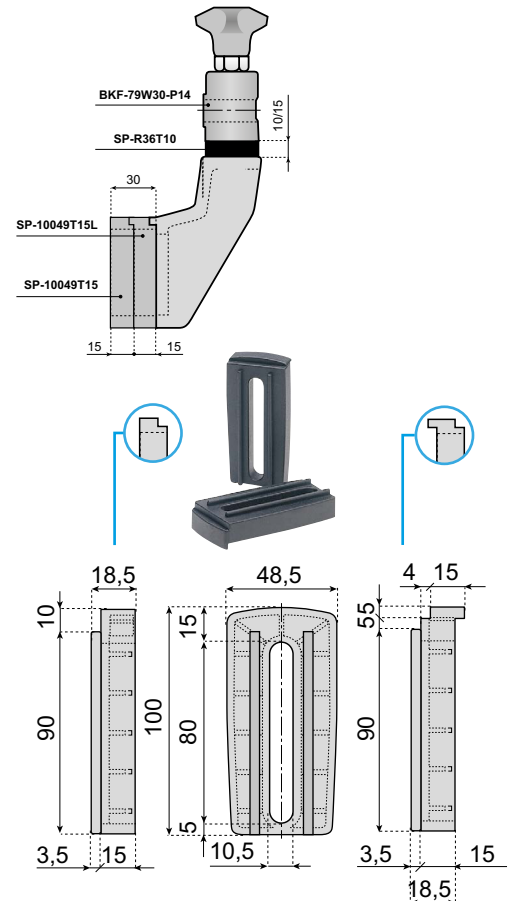

		PLASTIC			
		Ø 12	Ø 14	Ø 16	Ø 20
PLASTIC		ITEM DESCRIPTION			
	Without lip	BKR-72W43P-P12	BKR-72W43P-P14	BKR-72W43P-P16 *	BKR-72W43P-P20
	With lip	BKR-77W43LP-P12	BKR-77W43LP-P14	BKR-77W43LP-P16 *	BKR-77W43LP-P20
STAINLESS STEEL AISI 304		ITEM DESCRIPTION			
	Without lip	BKR-72W43S-P12	BKR-72W43S-P14	BKR-72W43S-P16 *	-
	With lip	BKR-77W43LS-P12	BKR-77W43LS-P14	BKR-77W43LS-P16 *	-

TYPE	MATERIAL	ITEM DESCRIPTION	
	PA-FG	SP-10049T15	50
		SP-10049T15L	50

### SPACER FOR ADJUSTABLE HEADS IN PA-FG

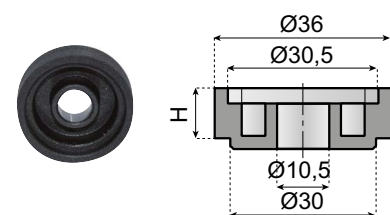

H	ITEM DESCRIPTION	
10	SP-R36T10	100
15	SP-R36T15	

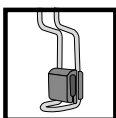

Suitable for drip tray brackets go to:

## 53600a

\* Suitable with Speedset™ adjustment:

## 53595a

### ADJUSTING BRACKET

**Material:** bracket and adjustable head in reinforced polyamide; eyebolt, nut, screws and washer in stainless steel AISI 304; knob in polyamide with nickel plated brass insert.

**Note:** screw regulates rod position and head adjustability. Max recommended tightening torque 4 Kgm.



For other type of brackets, go to:

## 53535b

Chains & sprockets	Wear strips	<b>Side guide brackets &amp; accessories</b>	Levelers	Engineering manual
Modular belts & sprockets	Chain & belt return systems	Frame & structure supports	Bearing supports	
Curves & tracks	Side guide solutions	Miscellaneous products	Equipment	

## 5 3 5 3 5 b

## SIDE GUIDE BRACKETS - SWIVEL TOP

www.SystemPlastSmartGuide.com

**Material:** reinforced polyamide, eyebolt and washer in stainless steel AISI 304, knob in polyamide with nickel plated brass insert.

**Note:** max recommended tightening torque 4 Kgm.

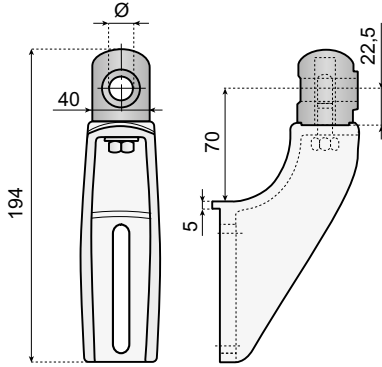

### VERSION WITH CLOSED TOP

	Ø 12	Ø 14	Ø 16	
	<b>ITEM DESCRIPTION</b>			
Without lip	BKR-70W43P-P12B	BKR-70W43P-P14B	BKR-70W43P-P16B	50
With lip	BKR-75W43LP-P12B	BKR-75W43LP-P14B	BKR-75W43LP-P16B	50

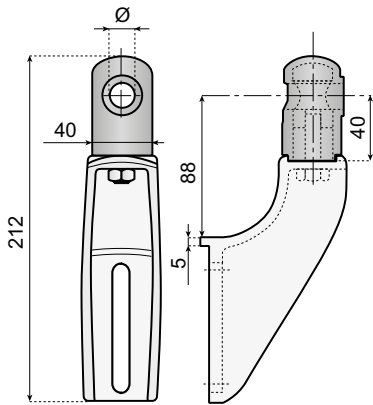

### VERSION WITH CLOSED TOP (HIGH)

	Ø 12	
	<b>ITEM DESCRIPTION</b>	
Without lip	BKR-88W43P-P12B	50
With lip	BKR-93W43LP-P12B	50

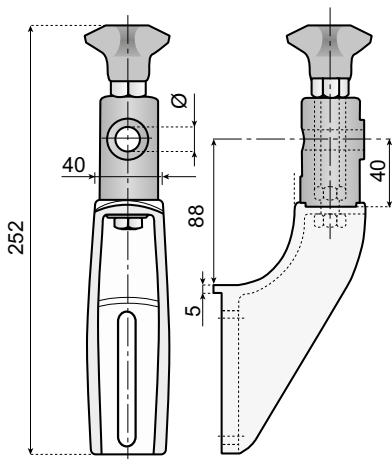

### VERSION WITH HIGH TOP

	Ø 12	Ø 14	Ø 16	
	<b>ITEM DESCRIPTION</b>			
Without lip	BKR-88W43P-P12	BKR-88W43P-P14	BKR-88W43P-P16	50
With lip	BKR-93W43LP-P12	BKR-93W43LP-P14	BKR-93W43LP-P16	50

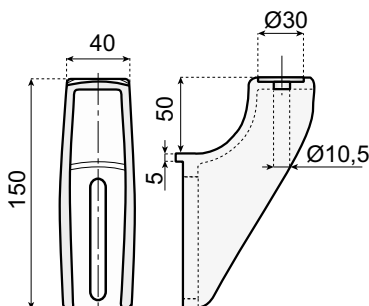

### VERSION WITHOUT TOP

	MATE-RIAL	ITEM DESCRIPTION	
Without lip	PA-FG	BK-50W43	50
With lip		BK-55W43L	50



For other type of brackets, go to:

**5 3 5 3 5 a**



For spacer for brackets, go to:

**5 3 5 3 5 a**

Chains & sprockets	Wear strips	Side guide brackets & accessories	Levelers	Engineering manual
Modular belts & sprockets	Chain & belt return systems	Frame & structure supports	Bearing supports	
Curves & tracks	Side guide solutions	Miscellaneous products	Equipment	

**5 3 5 4 5 a**

## SIDE GUIDE BRACKETS - SWIVEL TOP

www.SystemPlastSmartGuide.com

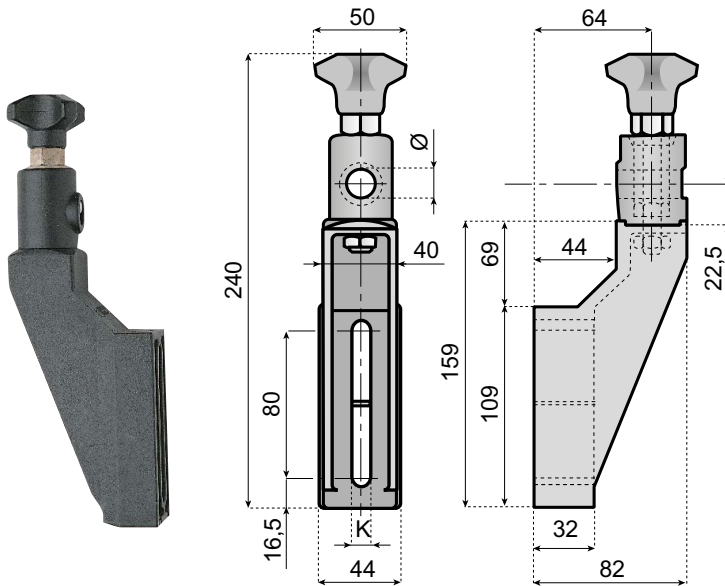

### ACCESSORIES

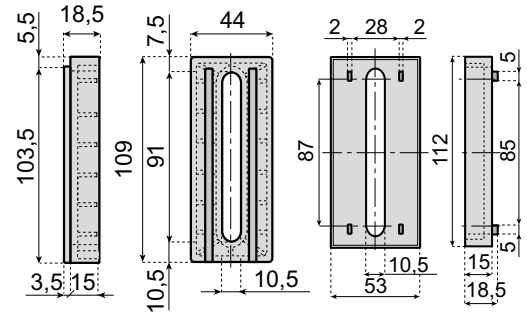
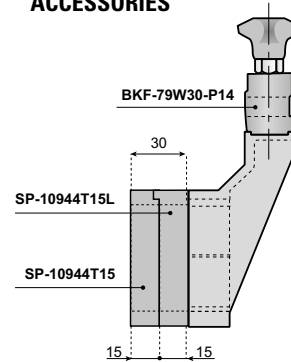

SP-10944T15

SP-11253T15

		PLASTIC		
		Ø 12	Ø 14	Ø 16
PLASTIC		ITEM DESCRIPTION		
	Slot K 8,5	BKR-69W44P-85P12	BKR-69W44P-85P14	BKR-69W44P-85P16
	Slot K 10,5	BKR-69W44P-105P12	BKR-69W44P-105P14	BKR-69W44P-105P16
STAINLESS STEEL AISI 304		ITEM DESCRIPTION		
	Slot K 8,5	BKR-69W44S-85P12	BKR-69W44S-85P14	BKR-69W44S-85P16
	Slot K 10,5	BKR-69W44S-105P12	BKR-69W44S-105P14	BKR-69W44S-105P16

TYPE	MATERIAL	ITEM DESCRIPTION	
Without lip	PA-FG	SP-10944T15	50
With lip		SP-11253T15	50

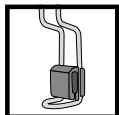

Suitable for drip tray brackets go to:

**5 3 6 0 0 a**



For other type of brackets, go to:

**5 3 5 4 5 b**



Information about this product is only available on our Smart Guide® website.

### ADJUSTABLE BRACKET

**Material:** bracket and adjustable head in reinforced polyamide; eyebolt, nut, screws and washer in stainless steel AISI 304; knob in polyamide PA-FG with nickel plated brass insert.

**Note:** screw regulates rod position and head adjustability. Max recommended tightening torque 4 Kgm.

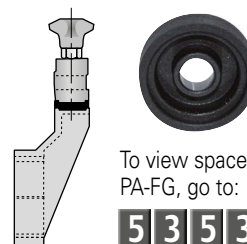

To view spacer for adjustable heads in PA-FG, go to:

**5 3 5 3 5 a**



Chains & sprockets	Wear strips	<b>Side guide brackets &amp; accessories</b>	Levelers	Engineering manual
Modular belts & sprockets	Chain & belt return systems	Frame & structure supports	Bearing supports	
Curves & tracks	Side guide solutions	Miscellaneous products	Equipment	

## 5 3 5 4 5 b

## SIDE GUIDE BRACKETS - SWIVEL TOP

www.SystemPlastSmartGuide.com

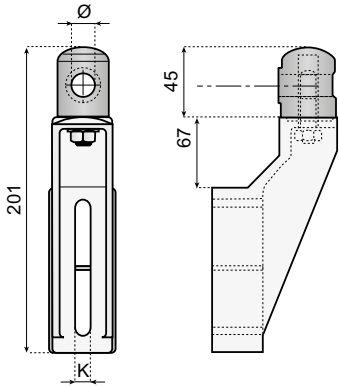

**VERSION WITH CLOSED TOP**

SLOT K	Ø 12	Ø 14	Ø 16	
	ITEM DESCRIPTION			
8,5	BKR-67W44P-85P12B	BKR-67W44P-85P14B	BKR-67W44P-85P16B	50
10,5	BKR-67W44P-105P12B	BKR-67W44P-105P14B	BKR-67W44P-105P16B	

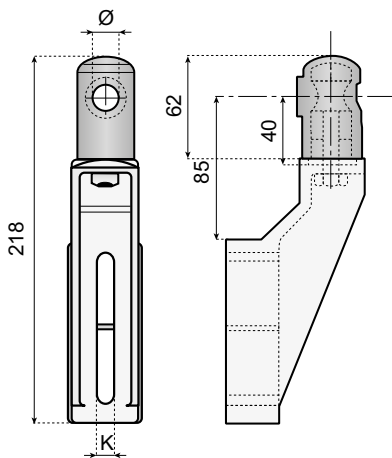

**VERSION WITH CLOSED TOP (HIGH)**

SLOT K	Ø 12	
	ITEM DESCRIPTION	
8,5	BKR-85W44P-85P12B	50
10,5	BKR-85W44P-105P12B	

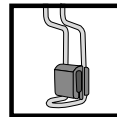

Suitable for drip tray brackets; go to:

**5 3 6 0 0 a**

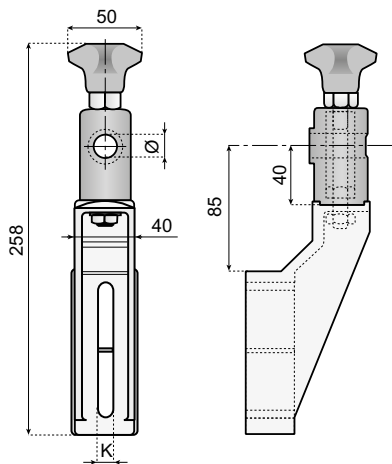

**VERSION WITH HIGH TOP**

SLOT K	Ø 12	Ø 14	Ø 16	
	ITEM DESCRIPTION			
8,5	BKR-85W44P-85P12	BKR-85W44P-85P14	BKR-85W44P-85P16	50
10,5	BKR-85W44P-105P12	BKR-85W44P-105P14	BKR-85W44P-105P16	

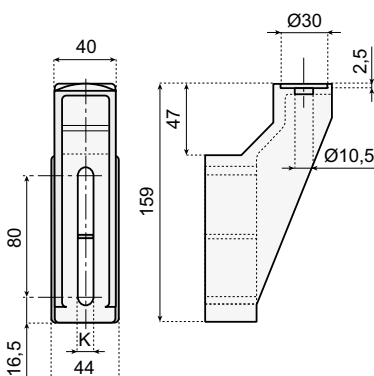

**VERSION WITHOUT TOP**

MATERIAL	SLOT K	ITEM DESCRIPTION	
PA-FG	8,5	BK-47W44-85	50
	10,5	BK-47W44-105	



Information about this product is only available on our Smart Guide® website.



For other type of brackets, go to:

**5 3 5 4 5 a**



For spacer for brackets, go to:

**5 3 5 4 5 a**

Chains & sprockets	Wear strips	Side guide brackets & accessories	Levelers	Engineering manual
Modular belts & sprockets	Chain & belt return systems	Frame & structure supports	Bearing supports	
Curves & tracks	Side guide solutions	Miscellaneous products	Equipment	



## 5 3 5 5 5 a

## SIDE GUIDE BRACKETS-FIXED OTHER VERSIONS

www.SystemPlastSmartGuide.com

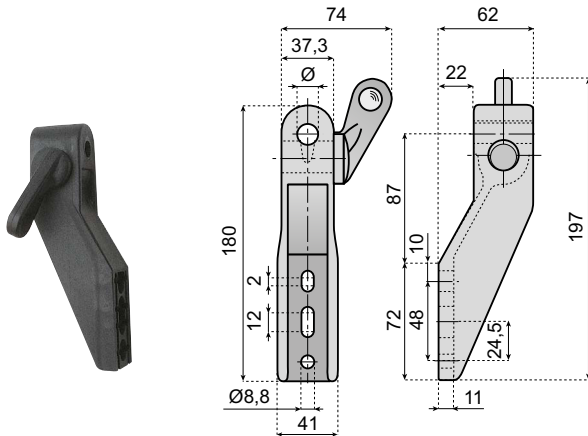

MATERIAL	Ø 12	Ø 14	
	ITEM DESCRIPTION		
PA-FG	BKE-85W22-P12	BKE-85W22-P14	50

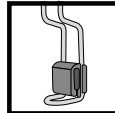

Suitable for drip tray brackets go to:

**5 3 6 0 0 a**

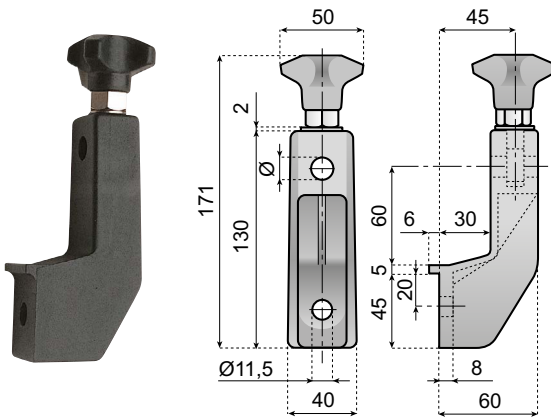

MATERIAL	Ø 12	
	ITEM DESCRIPTION	
PA-FG	BKF-65W30L-P12	50

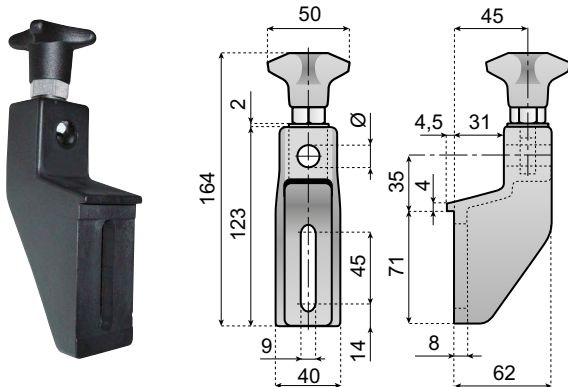

MATERIAL	Ø 12	Ø 14	
	ITEM DESCRIPTION		
PA-FG	BKF-35W31L-P12	BKF-35W31L-P14	50

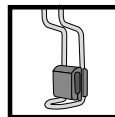

Suitable for drip tray brackets go to:

**5 3 6 0 0 a**

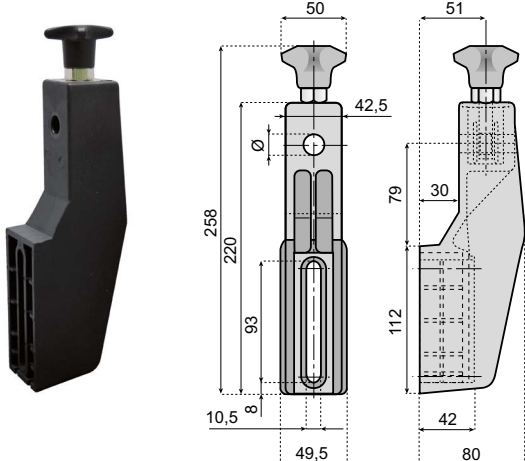

**Material:** bracket in reinforced polyamide; eyebolt, and washer in stainless steel AISI 304; knob in polyamide with nickel plated brass insert.

**Note:** max recommended tightening torque 4 Kgm.

MATERIAL	Ø 12	Ø 16
	ITEM DESCRIPTION	
PA-FG	BKF-79W30-P12	BKF-79W30-P14



For spacer for brackets, go to:

**5 3 5 4 5 a**

Chains & sprockets	Wear strips	Side guide brackets & accessories	Levelers	Engineering manual
Modular belts & sprockets	Chain & belt return systems	Frame & structure supports	Bearing supports	
Curves & tracks	Side guide solutions	Miscellaneous products	Equipment	

**5 3 5 6 0 a**

## SIDE GUIDE BRACKETS - FIXED TOP

[www.SystemPlastSmartGuide.com](http://www.SystemPlastSmartGuide.com)

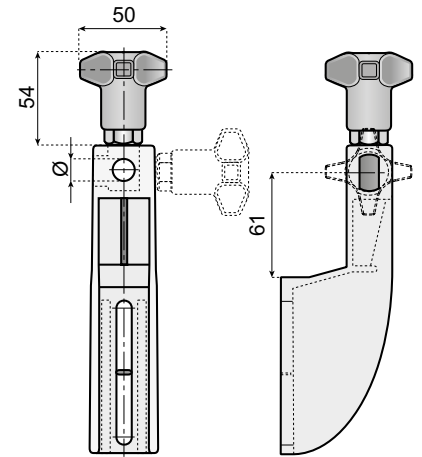
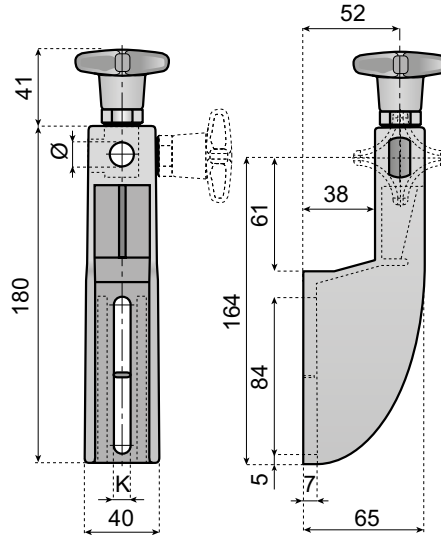

**WITH HIGH KNOB**

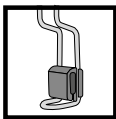

Suitable for drip tray brackets go to:

**5 3 6 0 0 a**

SLOT K	Ø 12		
	ITEM DESCRIPTION		
9	BKF-61W38-90P12		50
10,5	BKF-61W38-105P12		

SLOT K	Ø 12		
	ITEM DESCRIPTION		
9	BKF-61W38-90P12H		50
10,5	BKF-61W38-105P12H		

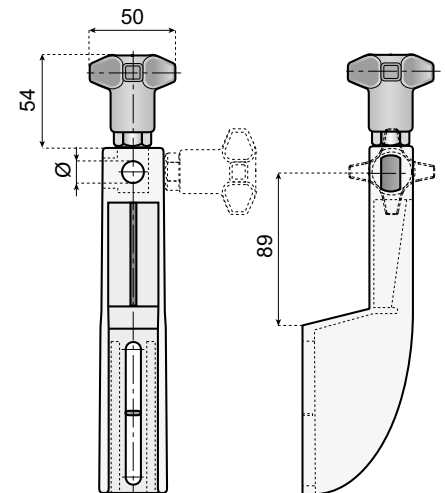
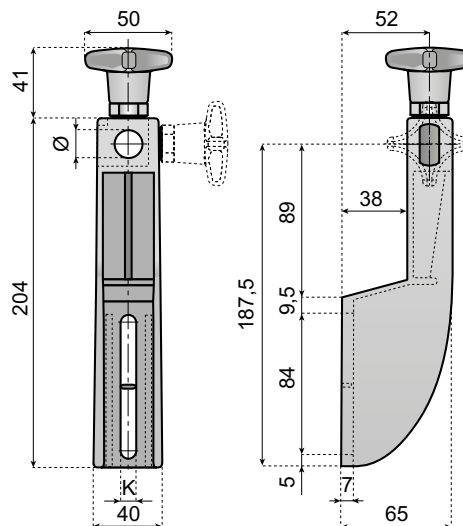

### BRACKET WITH EYEBOLT AND KNOB

**Material:** reinforced polyamide, eyebolt and washer in stainless steel AISI 304, knob in polyamide with nickel plated brass insert.

**Note:** max recommended tightening torque 4 Kgm.

SLOT K	Ø 12		
	ITEM DESCRIPTION		
9	BKF-89W38-90P12		50
10,5	BKF-89W38-105P12		

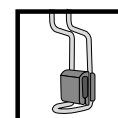

Suitable for drip tray brackets go to:

**5 3 6 0 0 a**

**WITH HIGH KNOB**

SLOT K	Ø 12		
	ITEM DESCRIPTION		
9	BKF-89W38-90P12H		50
10,5	BKF-89W38-105P12H		

Chains & sprockets	Wear strips	Side guide brackets & accessories	Levelers	Engineering manual
Modular belts & sprockets	Chain & belt return systems	Frame & structure supports	Bearing supports	
Curves & tracks	Side guide solutions	Miscellaneous products	Equipment	

## 5 3 5 6 5 a

### SIDE GUIDE BRACKETS - STAINLES STEEL

www.SystemPlastSmartGuide.com

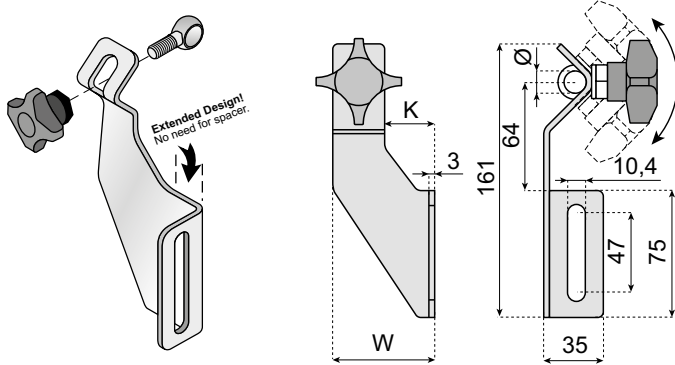

\* Suitable with Speedset™ adjustment:

## 5 3 5 9 5 a

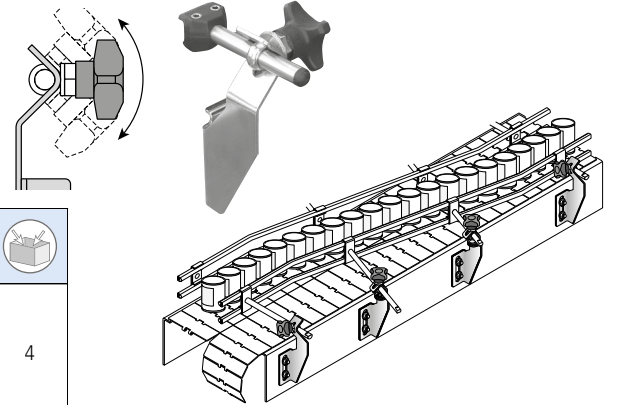

W	K	Ø 12-13	Ø 14	Ø 16	Ø 20	
ITEM DESCRIPTION						
60	29	VG-213-12-01	VG-213-14-01	VG-213-58-01	* VG-213-20-01	4
77,5	48	VG-213-12-02	VG-213-14-02	VG-213-58-02	* VG-213-20-02	

#### VALU GUIDE® STAINLESS STEEL GUIDE RAIL BRACKETS

**Material:** body in stainless steel, eyebolt and washer in stainless steel AISI 304, knob in reinforced polyamide with nickel plated brass insert.

**Note:** Versatile, sanitary design, high temperature or corrosive environments, tall or short, fixed or swivel.

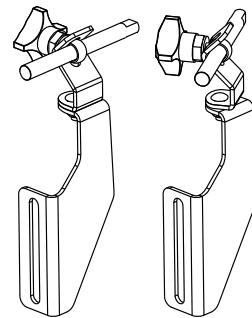
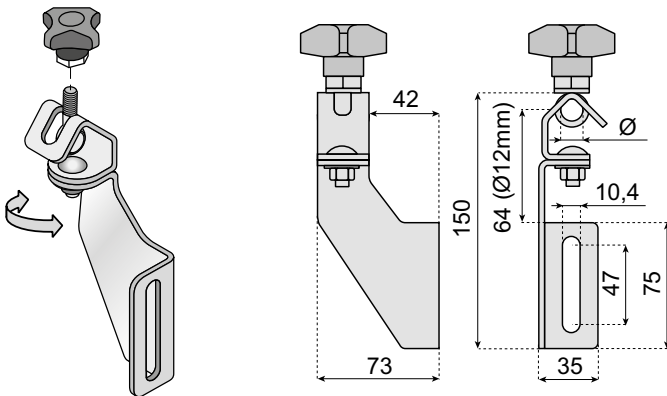

Ø 12-13	Ø 14	Ø 16	Ø 20	
ITEM DESCRIPTION				
VG-213R-12-01	VG-213R-14-01	VG-213R-58-01	* VG-213R-20-01	4

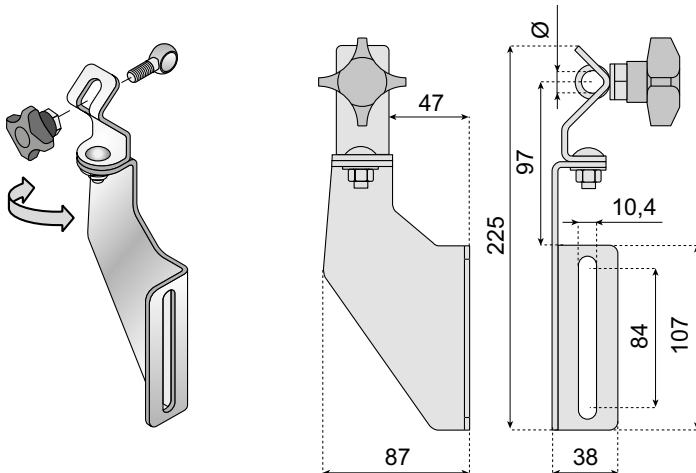

Ø 12-13	Ø 14	Ø 16	Ø 20	
ITEM DESCRIPTION				
VG-223R-12-01	VG-223R-14-01	VG-223R-58-01	* VG-223R-20-01	4

Chains & sprockets	Wear strips	<b>Side guide brackets &amp; accessories</b>	Levelers	Engineering manual
Modular belts & sprockets	Chain & belt return systems	Frame & structure supports	Bearing supports	
Curves & tracks	Side guide solutions	Miscellaneous products	Equipment	

**5 3 5 7 0 a**

## LATERAL BRACKETS - STAINLESS STEEL

[www.SystemPlastSmartGuide.com](http://www.SystemPlastSmartGuide.com)

For plastic version, go to:

**5 3 6 2 5 a**



### STAINLESS STEEL GUIDE RAIL BRACKETS

**Material type A:** body in stainless steel, insert in nickel plated brass, screw in stainless steel.

**Material type B:** body in stainless steel, eyebolt and washer in stainless steel, knob in reinforced polyamide with nickel plated brass insert.

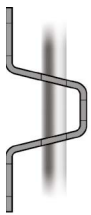
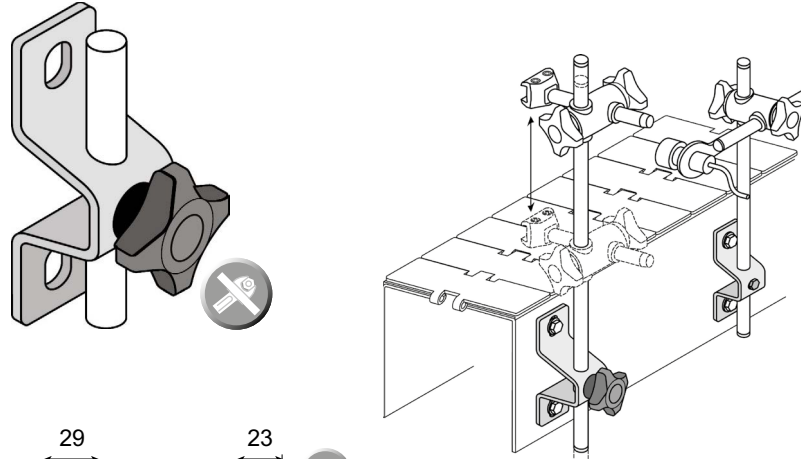

<b>Ø 12-13</b>		
<b>ITEM DESCRIPTION</b>		
<b>VG-254K-S-12</b>		10

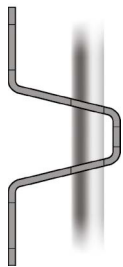
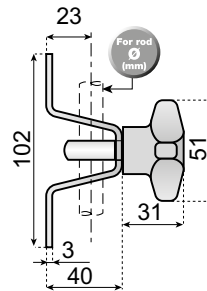
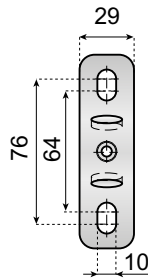

<b>Ø 12-13</b>	<b>Ø 16</b>	
<b>ITEM DESCRIPTION</b>		
<b>VG-253K-S-12</b>	<b>VG-253K-S-58</b>	10

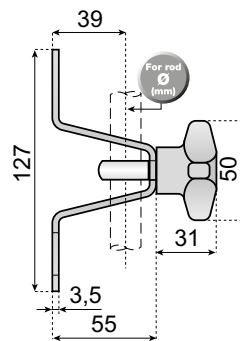
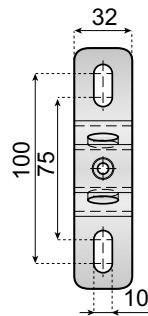

Chains & sprockets	Wear strips	<b>Side guide brackets &amp; accessories</b>	Levelers	Engineering manual
Modular belts & sprockets	Chain & belt return systems	Frame & structure supports	Bearing supports	
Curves & tracks	Side guide solutions	Miscellaneous products	Equipment	

**5 3 5 7 5 a**

## ANGLE BRACKETS - THERMOPLASTIC

[www.SystemPlastSmartGuide.com](http://www.SystemPlastSmartGuide.com)



### POLYAMIDE BRACKETS

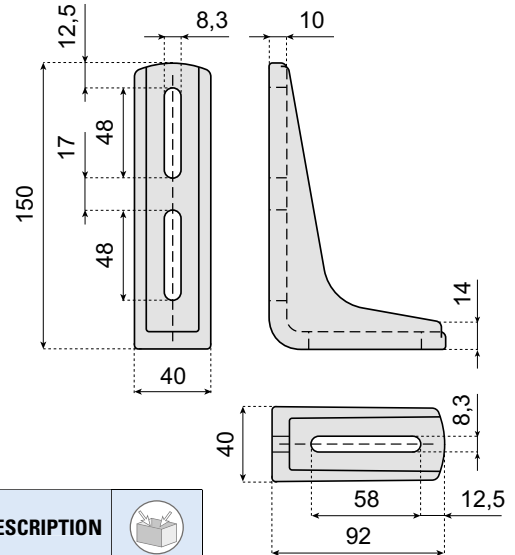
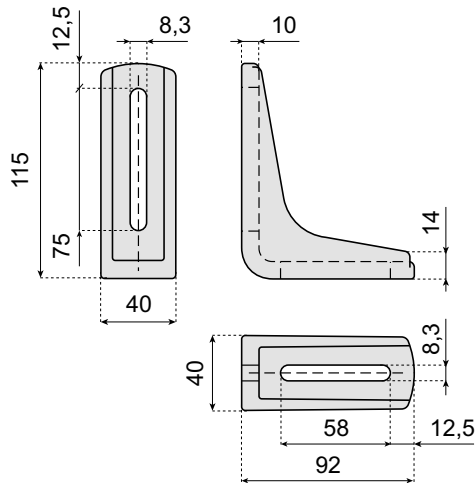
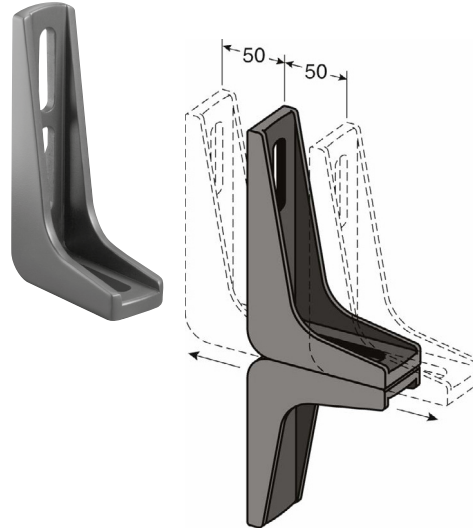
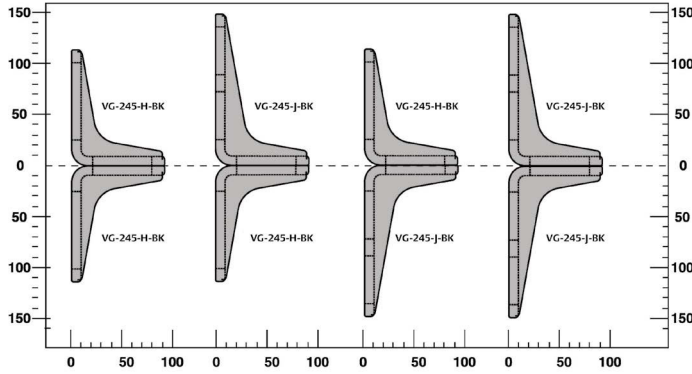

ITEM DESCRIPTION	
VG-245-H-BK	10

ITEM DESCRIPTION	
VG-245-J-BK	10

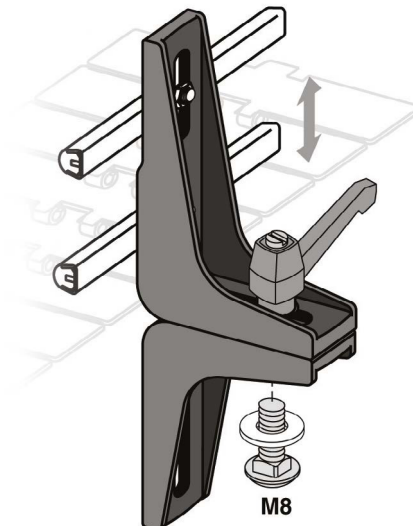

Chains & sprockets	Wear strips	Side guide brackets & accessories	Levelers	Engineering manual
Modular belts & sprockets	Chain & belt return systems	Frame & structure supports	Bearing supports	
Curves & tracks	Side guide solutions	Miscellaneous products	Equipment	

5 3 5 8 0 a

## ANGLE BRACKETS - STAINLESS STEEL

[www.SystemPlastSmartGuide.com](http://www.SystemPlastSmartGuide.com)

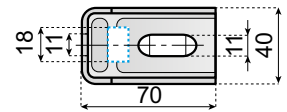
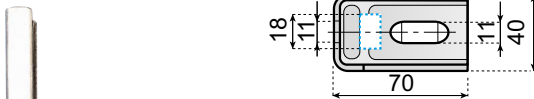
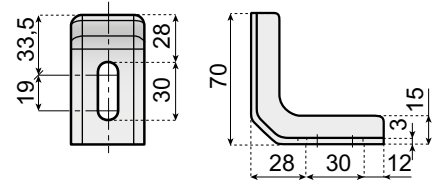
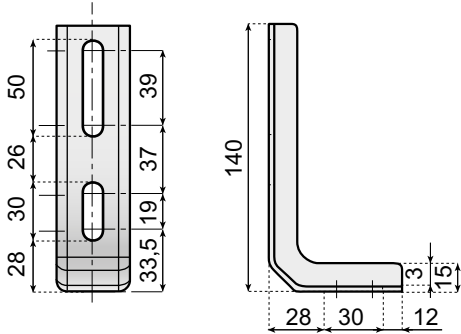
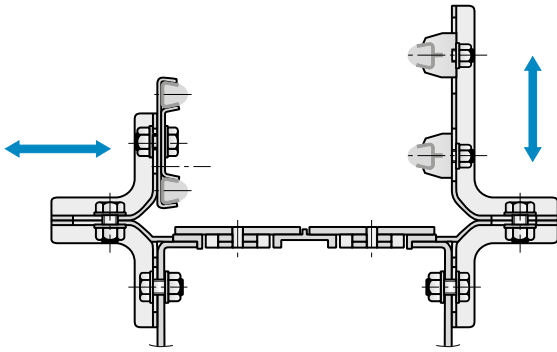

	<b>MATERIAL</b>	<b>ITEM DESCRIPTION</b>	
<b>WITHOUT LIP</b>	<b>STAINLESS STEEL AISI 304</b>	<b>BKL-140L70-SS</b>	50

	<b>MATERIAL</b>	<b>ITEM DESCRIPTION</b>	
<b>WITHOUT LIP</b>	<b>STAINLESS STEEL AISI 304</b>	<b>BKL-70L70-SS</b>	50

### FIXED BRACKET

**Thickness:** S = 2.5 mm.  
**Surface:** tumbling finish.  
**Use:** support for side guides.

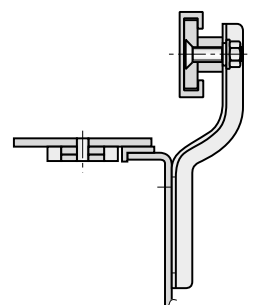
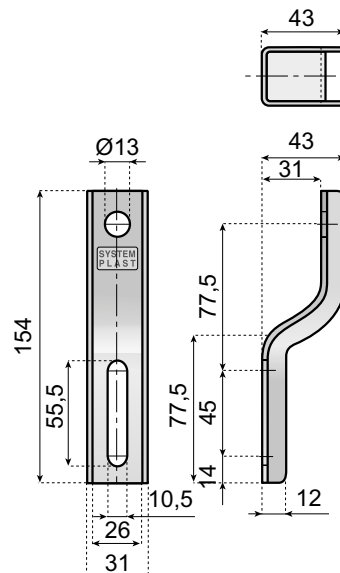

	<b>MATERIAL</b>	<b>ITEM DESCRIPTION</b>	
<b>WITHOUT LIP</b>	<b>STAINLESS STEEL AISI 304</b>	<b>BKZ-154-SS</b>	50

Chains & sprockets	Wear strips	Side guide brackets & accessories	Levelers	Engineering manual
Modular belts & sprockets	Chain & belt return systems	Frame & structure supports	Bearing supports	
Curves & tracks	Side guide solutions	Miscellaneous products	Equipment	

## 5 3 5 8 5 a

## MOUNTING TOP

www.SystemPlastSmartGuide.com

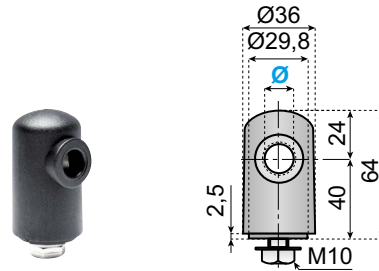
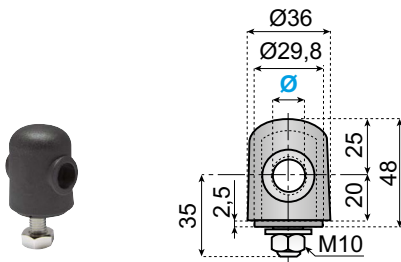

**Material:** reinforced polyamide; eyebolt, nut and washer in stainless steel AISI 304.

**Material:** head in reinforced polyamide, insert in nickel plated brass, screw and washer in stainless steel AISI 304.

Ø 12	Ø 14	Ø 16	ITEM DESCRIPTION	
TOP-20P-P12B	TOP-20P-P14B	TOP-20P-P16B		

Ø 12	ITEM DESCRIPTION	
TOP-40P-P12BB		

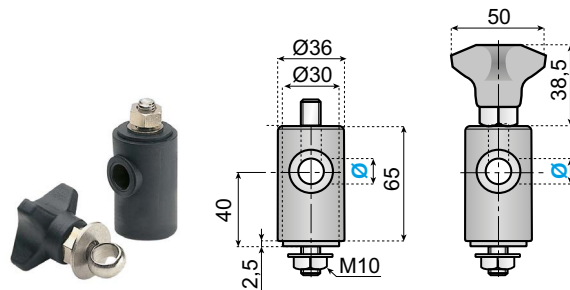
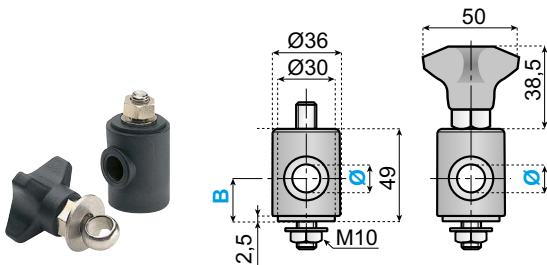

**Material:** reinforced polyamide, eyebolt, screw, nut, washer in stainless steel AISI 304, nut and hexagonal bushing in nickel plated brass.

**Material:** reinforced polyamide, eyebolt, screw, nut, washer in stainless steel AISI 304, nut and hexagonal bushing in nickel plated brass.

Ø	B	VERSION WITHOUT KNOB	VERSION WITH KNOB	ITEM DESCRIPTION	
		12	23		
14	23	TOP-23P-P14T	TOP-23P-P14K		
16	23	TOP-23P-P16T	TOP-23P-P16K		
20	24	TOP-24P-P20T	TOP-24P-P20K		

Ø	VERSION WITHOUT KNOB	VERSION WITH KNOB	ITEM DESCRIPTION	
	12	TOP-40P-P12T		
14	TOP-40P-P14T	TOP-40P-P14K		
16	TOP-40P-P16T	TOP-40P-P16K		

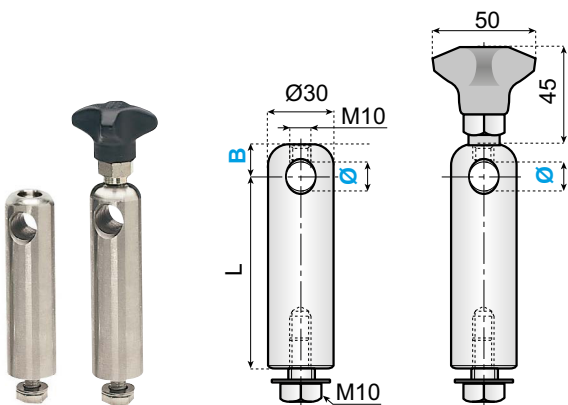
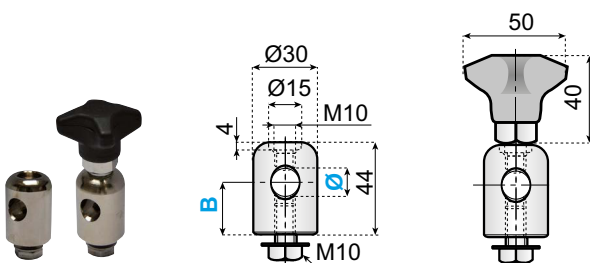

**Material:** screws and heads in stainless steel AISI 304.

**Material:** screws and heads in stainless steel AISI 304.

Ø	B	VERSION WITHOUT KNOB	VERSION WITH KNOB	ITEM DESCRIPTION	
		12	25		
14	24	TOP-24S-P14T	TOP-24S-P14K		
16	23	TOP-23S-P16T	TOP-23S-P16K		

Ø	L	B	VERSION WITHOUT KNOB	VERSION WITH KNOB	ITEM DESCRIPTION	
			12	40		
60	TOP-60S-P12T	TOP-60S-P12K				
90	TOP-90S-P12T	TOP-90S-P12K				
14	60	16	TOP-60S-P14T	TOP-60S-P14K		
	90		TOP-90S-P14T	TOP-90S-P14K		
16	40	17	TOP-40S-P16T	TOP-40S-P16K		
	60		TOP-60S-P16T	TOP-60S-P16K		
	90		TOP-90S-P16T	TOP-90S-P16K		

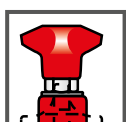

For other type of mounting block, go to:

## 5 3 5 9 0 a



Chains & sprockets	Wear strips	Side guide brackets & accessories	Levelers	Engineering manual
Modular belts & sprockets	Chain & belt return systems	Frame & structure supports	Bearing supports	
Curves & tracks	Side guide solutions	Miscellaneous products	Equipment	

**53590a**

## ROD MOUNTS

[www.SystemPlastSmartGuide.com](http://www.SystemPlastSmartGuide.com)



### VALU GUIDE® ROD MOUNTS

New Valu Guide Rod Mounts, used for holding and positioning adjusting rods. These strong, yet economical mounts are available in a selection of rod diameter sizes, fixed or rotating configurations, and various tightening methods.

**Material:** rod mounts in stainless steel, eyebolt and washer and nuts in stainless steelknob in polyamide with nickel plated brass insert.

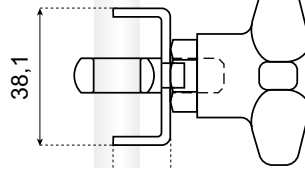
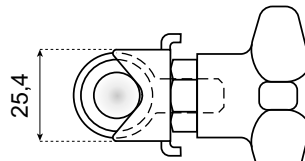
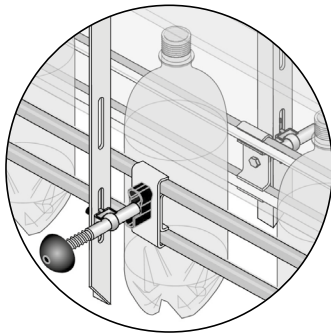

16 mm (12 – 13 mm rod)  
17,5 mm (14 mm rod)  
19 mm (16 mm rod)  
22 mm (20 mm rod)

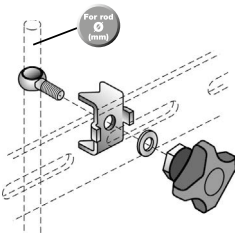
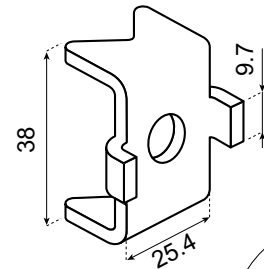
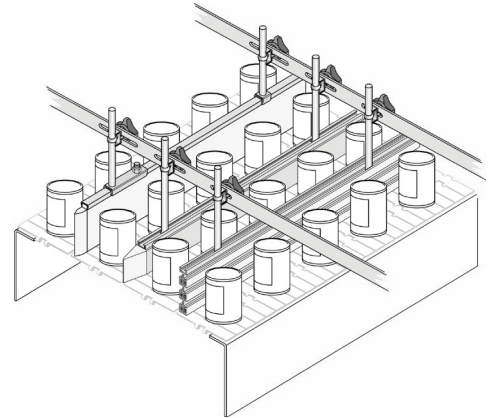

#### WITH KNOB

Ø 12-13	Ø 14	Ø 16	Ø 20	
ITEM DESCRIPTION				
VG-641T-K-12	VG-641T-K-14	VG-641T-K-58	VG-641T-K-20	8

Positioning tabs lock the rod to brackets slots at 90°.

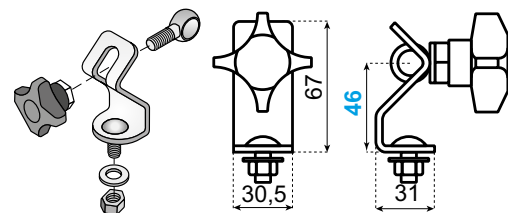
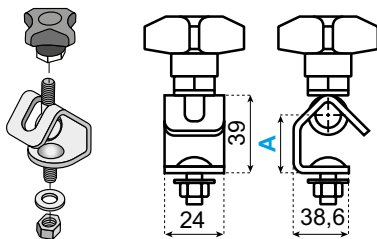
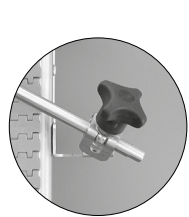
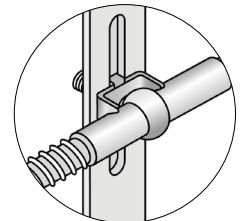

FOR ROD DIAMETER				
Ø 12-13	Ø 14	Ø 16	Ø 20*	
A = 29	A = 27,5	A = 26	A = 24	
ITEM DESCRIPTION				
VG-213R-TOP-12	VG-213R-TOP-14	VG-213R-TOP-58	VG-213R-TOP-20	8

FOR ROD DIAMETER				
Ø 12-13	Ø 14	Ø 16	Ø 20*	
A = 46				
ITEM DESCRIPTION				
VG-223R-TOP-12	VG-223R-TOP-14	VG-223R-TOP-58	VG-223R-TOP-20	8

\* Ø20 versions can be converted to SpeedSet™ brackets

\* Ø20 versions can be converted to SpeedSet™ brackets

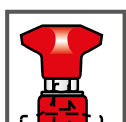

For other type of mounting block, go to:

**53585a**

Chains & sprockets	Wear strips	Side guide brackets & accessories	Levelers	Engineering manual
Modular belts & sprockets	Chain & belt return systems	Frame & structure supports	Bearing supports	
Curves & tracks	Side guide solutions	Miscellaneous products	Equipment	

## 5 3 5 9 5 a

## SPEEDSET™ - GUIDE RAIL ADJUSTMENT

www.SystemPlastSmartGuide.com

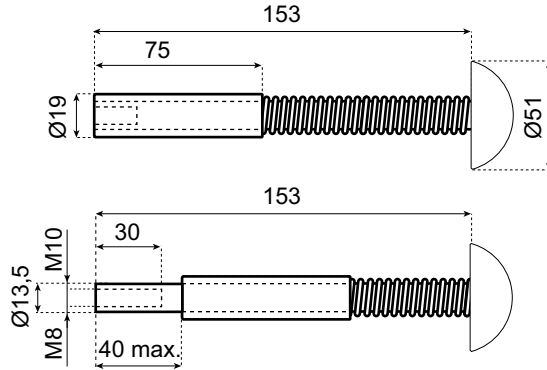

Speedset™ Adjustment units

ITEM DESCRIPTION	TRAVEL	
VG-Q-75-40-M8	0-40 mm	M8
VG-Q-75-40-M10		M10

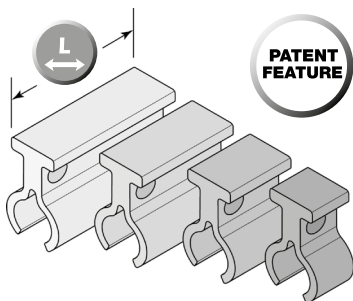
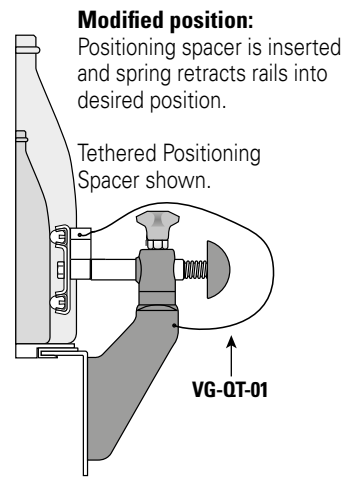
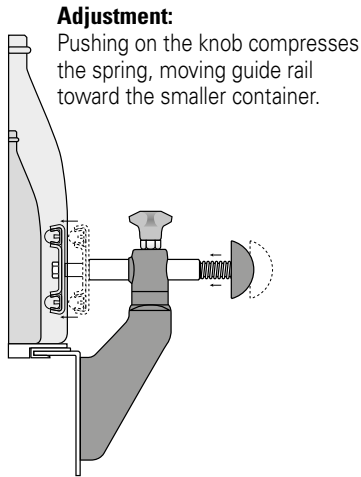
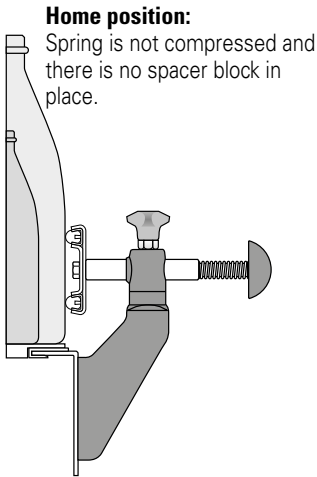

Can be connected to the bracket or the machine with the VG-QT-01 tether.

Clip-on spacers for SPEEDSET™

ITEM DESCRIPTION			
VG-QSC-10M	10 mm	Red	10
VG-QSC-12M	12 mm	Blue	
VG-QSC-16M	16 mm	Black	
VG-QSC-20M	20 mm	Green	
VG-QSC-25M	25 mm	Purple	
VG-QSC-30M	30 mm	Orange	
VG-QSC-40M	40 mm	Grey	
VG-QT-01	225 mm		

Various brackets are available for Speedset™ adjustment systems. Go to:

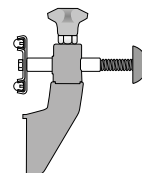

5 3 5 2 5 a  
5 3 5 3 5 a

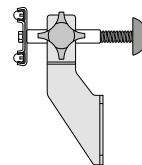

5 3 5 6 5 a

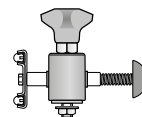

5 3 5 8 5 a

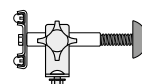

5 3 5 9 0 a

Chains & sprockets	Wear strips	Side guide brackets & accessories	Levelers	Engineering manual
Modular belts & sprockets	Chain & belt return systems	Frame & structure supports	Bearing supports	
Curves & tracks	Side guide solutions	Miscellaneous products	Equipment	

## 53600a

## DRIP TRAY BRACKETS

[www.SystemPlastSmartGuide.com](http://www.SystemPlastSmartGuide.com)



### DRIP TRAY SUPPORTS

**Material:** metal support in stainless steel AISI 304, clamp in polyamide.

**Accessories:** fixing washer code 13252

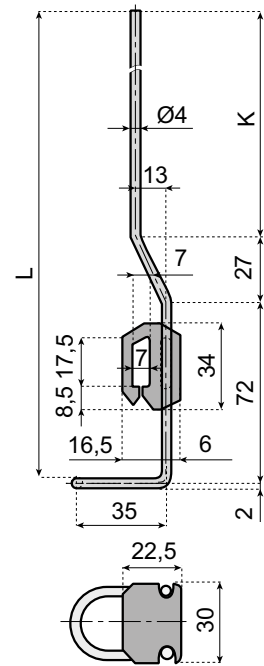
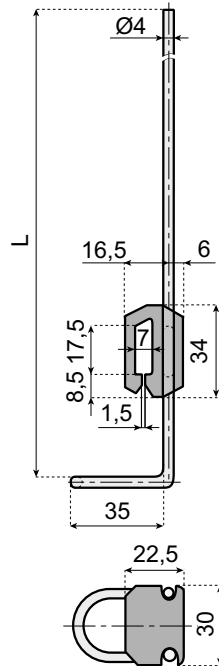
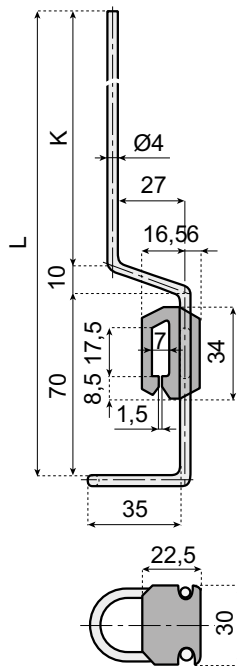
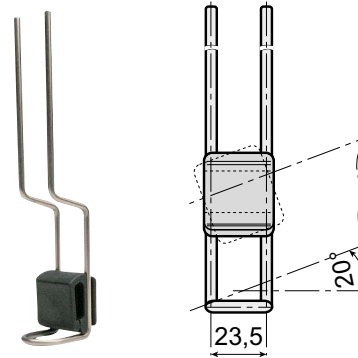

K mm	L mm	ITEM DESCRIPTION	
100	180	DTS-27H180	50
170	250	DTS-27H250	
200	280	DTS-27H280	

L mm	ITEM DESCRIPTION	
246	DTS-00H246	50
396	DTS-00H396	

K mm	L mm	ITEM DESCRIPTION	
83	180	DTS-13H180	50
153	250	DTS-13H250	

### FIXING WASHER

**Material:** polyamide, washer in stainless steel AISI 304.



ITEM DESCRIPTION	
DTS-R40	50

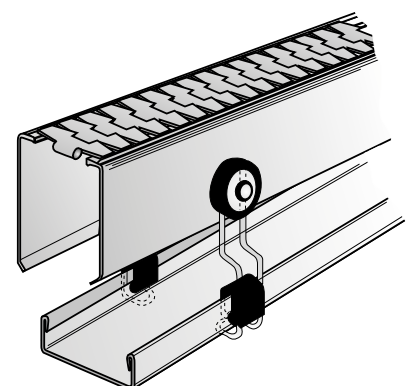
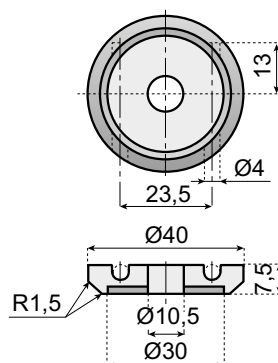

Chains & sprockets	Wear strips	Side guide brackets & accessories	Levelers	Engineering manual
Modular belts & sprockets	Chain & belt return systems	Frame & structure supports	Bearing supports	
Curves & tracks	Side guide solutions	Miscellaneous products	Equipment	

## 53605a

## PHOTOCELL CLAMP ASSEMBLY

[www.SystemPlastSmartGuide.com](http://www.SystemPlastSmartGuide.com)

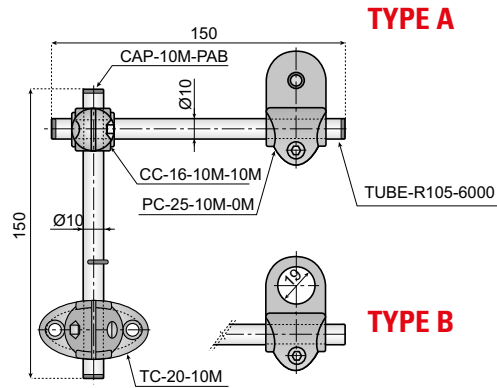
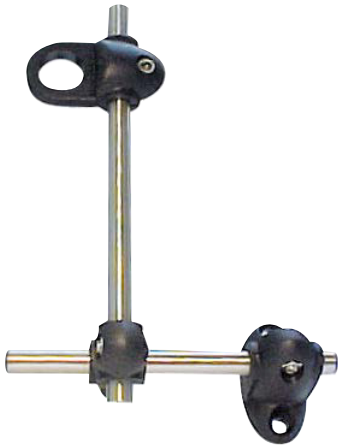

**Material:** clamps in reinforced polyamide, tightening bolt and connecting tubes in stainless steel AISI 304, closing caps in polyethylene.

**Components:** nr° 1 T-Clamp, nr° 1 clamp, nr° 1 cross block, nr° 2 connecting tubes, nr° 4 closing caps.

**Supply:** unassembled.

**\*Packaging:** 25 completely kit.

ITEM DESCRIPTION	Kit Icon
KIT TYPE A	
PC-KIT-0M	25*

ITEM DESCRIPTION	Kit Icon
KIT TYPE B	
PC-KIT-19M	25*

### LOOSE TUBE



**TUBE:**

- external d. 10 mm
- thickness 1 mm
- length 6 m

**Material:** Stainless Steel AISI 304

ITEM DESCRIPTION	Kit Icon
TUBE-R105-6000	50

### CAP

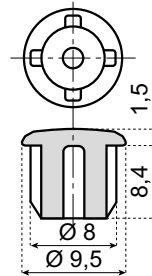

**Material:** PA-FG black

ITEM DESCRIPTION	Kit Icon
CAP-10M-PAB	50

Chains & sprockets	Wear strips	Side guide brackets & accessories	Levelers	Engineering manual
Modular belts & sprockets	Chain & belt return systems	Frame & structure supports	Bearing supports	
Curves & tracks	Side guide solutions	Miscellaneous products	Equipment	

## 5 3 6 1 0 a

## CROSS BLOCKS

www.SystemPlastSmartGuide.com



### HEAVY DUTY

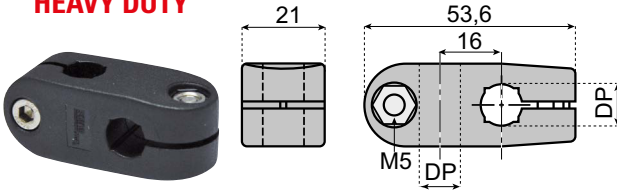

**Material:** Acetal resin with stainless steel fasteners.

DP	ITEM DESCRIPTION	
●10/■8	VG-619-10M	10
●12/■10	VG-619-12M	
●14/■12	VG-619-14M	

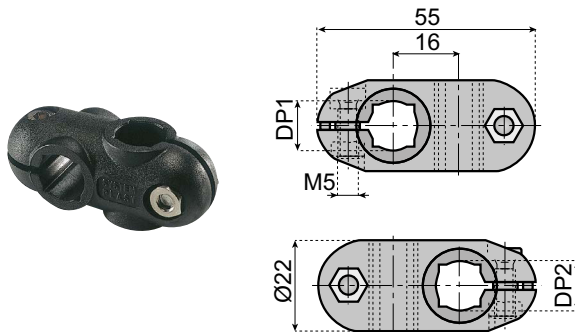

**Material:** Reinforced poliamyde with stainless steel fasteners.

DP 2	DP 1			
	●10/■8	●12/■10	●14/■12	
ITEM DESCRIPTION				
●10/■8	CC-16-10M-10M	-	-	50
●12/■10	CC-16-10M-12M	CC-16-12M-12M	-	
●14/■12	CC-16-10M-14M	CC-16-12M-14M	CC-16-14M-14M	

## PHOTOCELL CLAMP

### TYPE A T-CLAMP

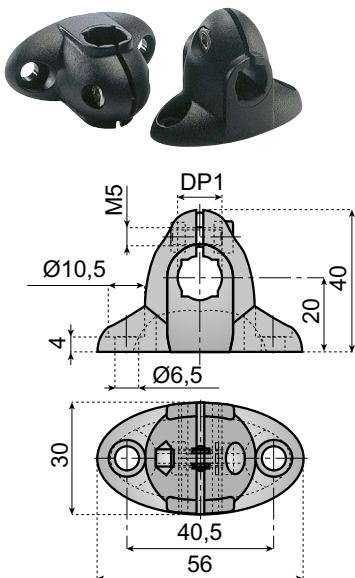

### TYPE B

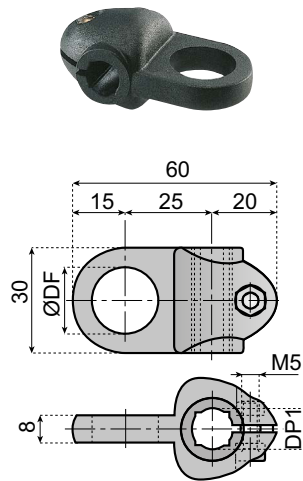

### TYPE C REFLECTOR CLAMP

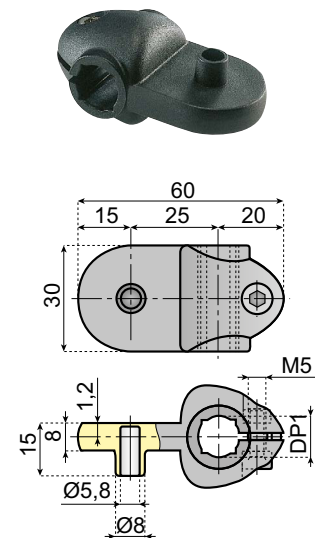

ITEM DESCRIPTION	TYPE	DP 1		Ø DF	
		●	■		
TC-20-10M	A	10	8	-	50
TC-20-12M		12	10	-	
TC-20-14M		14	12	-	

**Features:** used to hold reflectors using a cap screw and nut or pression clip.

**Material:** reinforced polyamide with stainless steel fasteners.

**Supply:** assembled.

ITEM DESCRIPTION	TYPE	DP 1			Ø DF	
		●	■	□		
PC-25-10M-8M	B	10	8	8	50	
PC-25-10M-12M		10	8	12		
PC-25-10M-19M		10	8	19		
PC-25-12M-8M		12	10	8		
PC-25-12M-12M		12	10	12		
PC-25-12M-19M		12	10	19		
PC-25-14M-12M		14	12	12		
PC-25-14M-19M		14	12	19		

ITEM DESCRIPTION	TYPE	DP 1		
		●	■	
PC-25-10M-0M	C	10	8	50
PC-25-12M-0M		12	10	
PC-25-14M-0M		14	12	



For other type of cross block go to:

5 3 6 1 5 a  
5 3 6 2 0 a

Chains & sprockets	Wear strips	Side guide brackets & accessories	Levelers	Engineering manual
Modular belts & sprockets	Chain & belt return systems	Frame & structure supports	Bearing supports	
Curves & tracks	Side guide solutions	Miscellaneous products	Equipment	

## 5 3 6 1 5 a

## STANDARD CROSS BLOCKS

[www.SystemPlastSmartGuide.com](http://www.SystemPlastSmartGuide.com)



**Features:** cross blocks, in a variety of bore configurations, including square bore combinations, are manufactured from reinforced polyamide.

**Use:** connects two round or square rods at 90°.

**Material:** reinforced polyamide with stainless steel fasteners.

**Supply:** assembled.

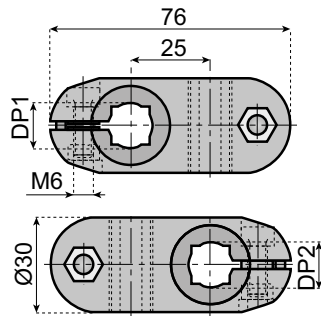

For other type of cross block, go to:

5 3 6 1 0 a  
5 3 6 2 0 a

DP 2	DP 1						
	●12/ ■10	●14/ ■12	●15	●16/ ■14	●18	●20/ ■16	
ITEM DESCRIPTION							
●12/ ■10	CC-25-12M-12M	-	-	-	-	-	50
●14/ ■12	-	CC-25-14M-14M	-	-	-	-	
●15	-	-	CC-25-15M-15M	-	-	-	
●16/ ■14	CC-25-12M-16M	CC-25-14M-16M	CC-25-15M-16M	CC-25-16M-16M	-	-	
●18	-	CC-25-14M-18M	CC-25-15M-18M	CC-25-16M-18M	CC-25-18M-18M	-	
●20/ ■16	-	CC-25-14M-20M	-	CC-25-16M-20M	CC-25-18M-20M	CC-25-20M-20M	

## EXTRA LONG CROSS OR PARALLEL BLOCKS

**Features:** cross blocks, in a variety of bore configurations, including square bore combinations.

**Material:** reinforced polyamide with stainless steel bolts. Internal connecting joint and pins in nickel plated brass.

**Supply:** assembled.

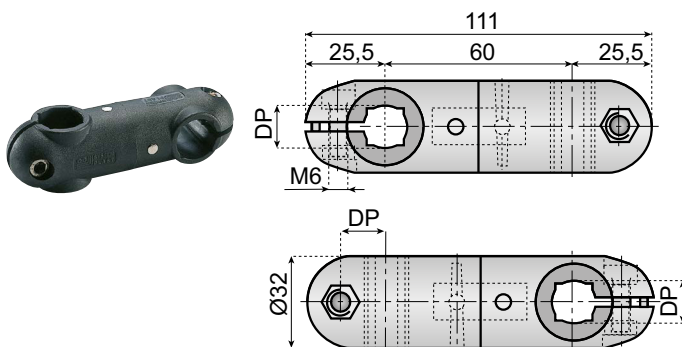

**Use:** it connects two round or square rods at 90°.

**These clamps can also be assembled for 2 parallel rods.**

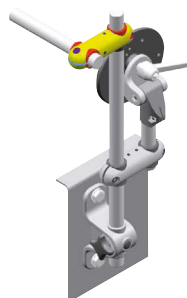

ITEM DESCRIPTION	DP		
	●	■	
VG-60-14M-14M	14	12	100
VG-60-18M-18M	18	-	
VG-60-20M-20M	20	16	

Chains & sprockets	Wear strips	Side guide brackets & accessories	Levelers	Engineering manual
Modular belts & sprockets	Chain & belt return systems	Frame & structure supports	Bearing supports	
Curves & tracks	Side guide solutions	Miscellaneous products	Equipment	

## 53620a

## CROSS BLOCKS

www.SystemPlastSmartGuide.com

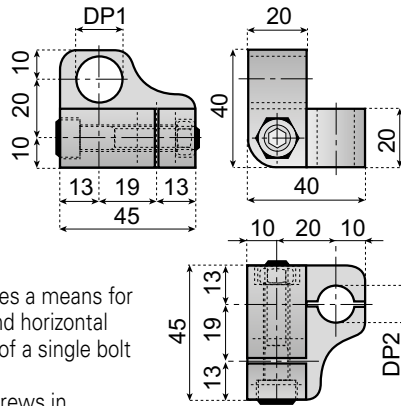

Example application

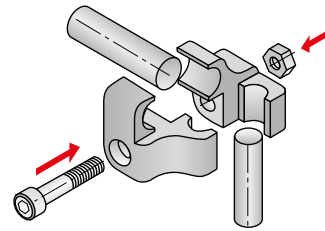

Adjustment with bolts

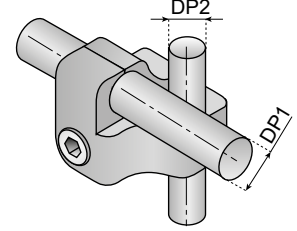

**Feature:** the special design provides a means for rapid adjustment of both vertical and horizontal side rail positions with the release of a single bolt or knob.

**Material:** reinforced polyamide, screws in stainless steel AISI 304.

**Supply:** assembled.

ITEM DESCRIPTION	DP 1	DP 2	
CC-20-12M-12M	12	12	50
CC-20-14M-14M	14	14	



**Material:** reinforced polyamide, knobs in polyamide with stainless steel insert.

**Use:** rod Ø 12 mm.

**Supply:** unassembled.

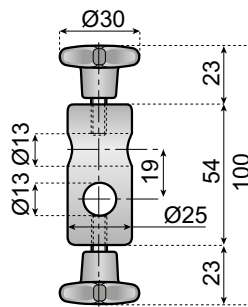

ITEM DESCRIPTION WITH STAR KNOBS	
CC-19-12MK-12MK	100



**Material:** housing in reinforced polyamide, hardware in stainless steel, knobs in polyamide with bushings in nickel plated brass.

**Features:** it connects two round rods at 90°. Each side of the cross block can be quickly adjusted by loosening the hand knob.

**Supply:** assembled.

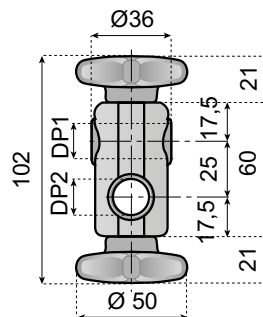

ITEM DESCRIPTION	DP 1	DP 2	
CC-25-12MK-12MK	12	12	50
CC-25-12MK-14MK	12	14	
CC-25-12MK-16MK	12	16	
CC-25-14MK-14MK	14	14	
CC-25-16MK-16MK	16	16	



**Components:**

- Housing in reinforced polyamide.
- Washer and hardware in stainless steel.
- Knobs in reinforced polyamide with one threaded insert in stainless steel and one brass bushing.

**Features:**

- Connects one round rod with flat bar at 90°.
- Each side of the cross block can be quickly adjusted by loosening the hand knob.

**Supply:** assembled.

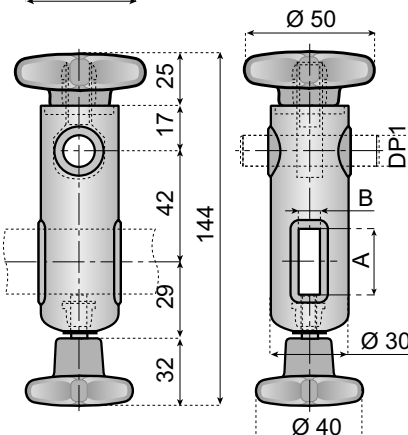

For other type of cross block go to:

53610a  
53615a

ITEM DESCRIPTION	DP 1	FLAT BAR	
CC-42-12MK-825MK	12	25x8	50
CC-42-12MK-625MK	12	25x6	

Chains & sprockets	Wear strips	Side guide brackets & accessories	Levelers	Engineering manual
Modular belts & sprockets	Chain & belt return systems	Frame & structure supports	Bearing supports	
Curves & tracks	Side guide solutions	Miscellaneous products	Equipment	

## 5 3 6 2 5 a

## T-CLAMP

www.SystemPlastSmartGuide.com



**Features:** mounts to side of equipment to provide support light duty rod type guide rail system.

**Material:** reinforced polyamide with stainless steel bolts; Internal connecting joints and pins in nickel plated brass.

**Supply:** assembled.

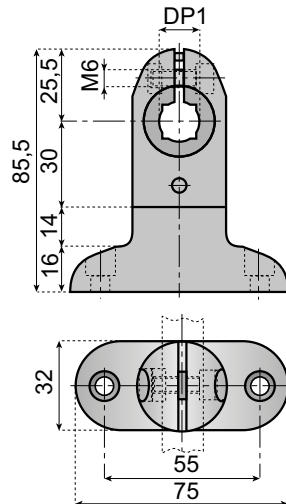

This clamp can also be assembled with the flange rotated 90°.

For stainless steel version, go to:

## 5 3 5 7 0 a

ITEM DESCRIPTION	DP 1		100
	●	■	
TC-60-14M	14	12	100
TC-60-18M	18	-	
TC-60-20M	20	16	

## BRACKET

**TYPE A**



**TYPE B**

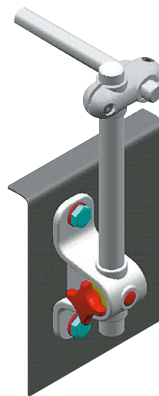

**TYPE A**

**TYPE B**

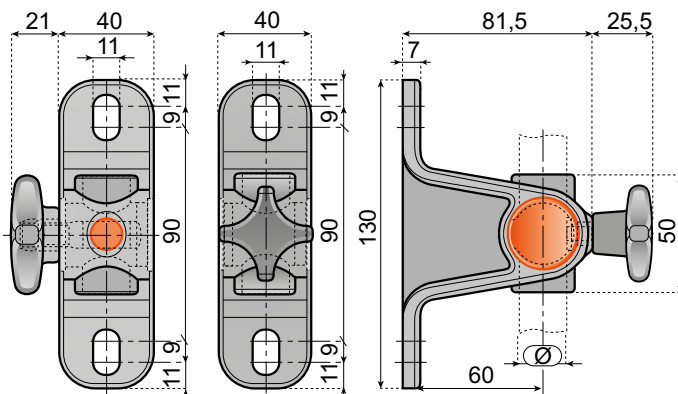

### BRACKET WITH HAND KNOB

**Material:** bracket in reinforced polyamide, eyelet in metal, knob in polyamide with bushing insert in nickel plated brass, washer in stainless steel.

**Features:** knob fastening provides holding and positioning for many rods. Heavy duty construction for increased strength and rigidity.

**Supply:** assembled.

TYPE A	TYPE B	FOR ROD Ø		50
		●	■	
SMB-60-14MK90	SMB-60-14MK	14	12	50
SMB-60-16MK90	SMB-60-16MK	16	14	
SMB-60-20MK90	SMB-60-20MK	20	16	





Chains & sprockets	Wear strips	<b>Side guide brackets &amp; accessories</b>	Levelers	Engineering manual
Modular belts & sprockets	Chain & belt return systems	Frame & structure supports	Bearing supports	
Curves & tracks	Side guide solutions	Miscellaneous products	Equipment	

**5 3 6 3 5 a**

## CLAMP FOR PHOTOCELLS REFLECTOR

[www.SystemPlastSmartGuide.com](http://www.SystemPlastSmartGuide.com)



**Material:** reinforced polyamide, tightening bolts in stainless steel AISI 304.  
**Use:** can be fitted in position **A - B - C**  
**Supply:** assembled, (position A).

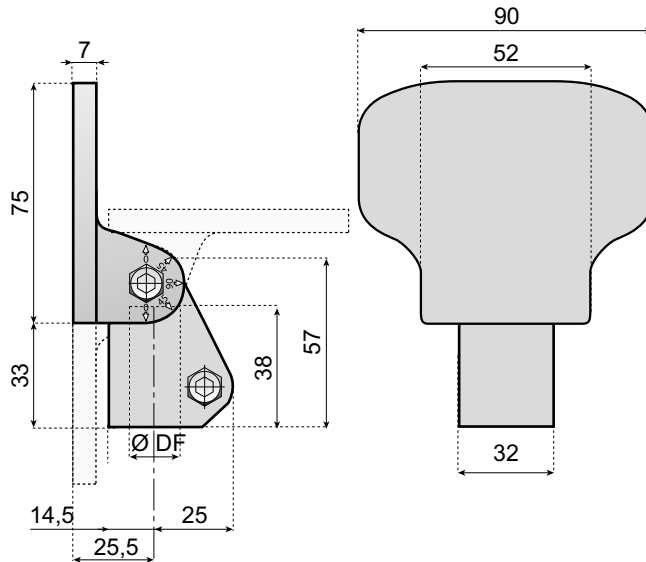

ITEM DESCRIPTION	Ø DF	 50
PC-9075-14M	14	
PC-9075-15M	15	
PC-9075-16M	16	
PC-9075-18M	18	
PC-9075-20M	20	

For other type of clamp for photocells, go to:

**5 3 6 4 0 a**

## PHOTOCELLS ACCESSORIES - INDICATORS



**Application:** activation of photocells on conveyors and machines.  
**Material:** PA-FG.

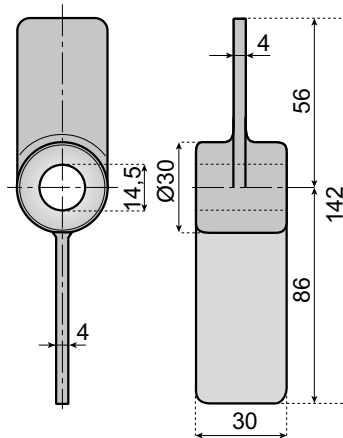

ITEM DESCRIPTION	 50
IND-142B-14M	



**Application:** activation of photocells on conveyors and machines.  
**Material:** PA-FG.

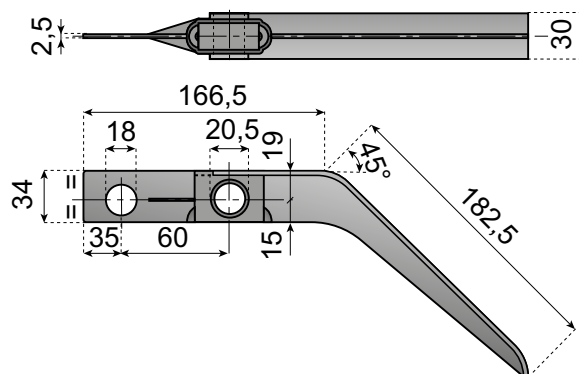

ITEM DESCRIPTION	 50
IND-350R18M-20M (WITH HOLE)	

Chains & sprockets	Wear strips	Side guide brackets & accessories	Levelers	Engineering manual
Modular belts & sprockets	Chain & belt return systems	Frame & structure supports	Bearing supports	
Curves & tracks	Side guide solutions	Miscellaneous products	Equipment	

**5 3 6 4 0 a**

## UNIVERSAL CLAMPS FOR PHOTOCELLS OR REFLECTORS

[www.SystemPlastSmartGuide.com](http://www.SystemPlastSmartGuide.com)



**Movement on the three axis**

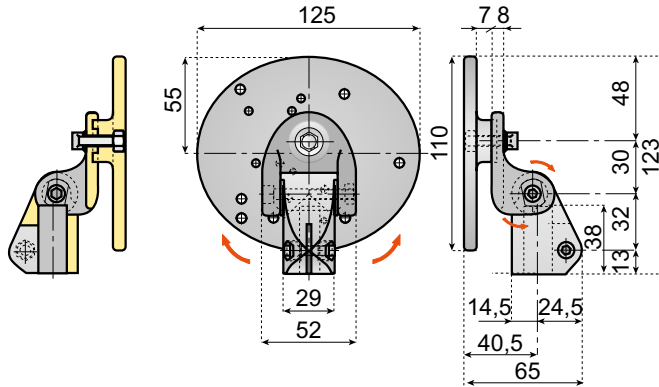

**Material:** clamp in reinforced polyamide, tightening bolt in stainless steel.

**Note:** max recommended tightening torque 2 Kgm.

**Supply:** assembled.

FOR ROD DIAMETER			
Ø 14	Ø 16	Ø 20	
ITEM DESCRIPTION			
PC-125110-14M	PC-125110-16M	PC-125110-20M	50

For other type of clamp for photocells go to:

**5 3 6 3 5 a**

## COMPLETE KIT FOR PHOTOCCELL

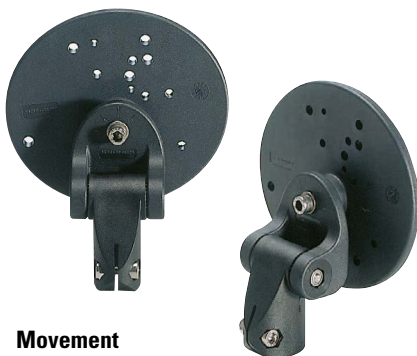

**Movement on the three axis**

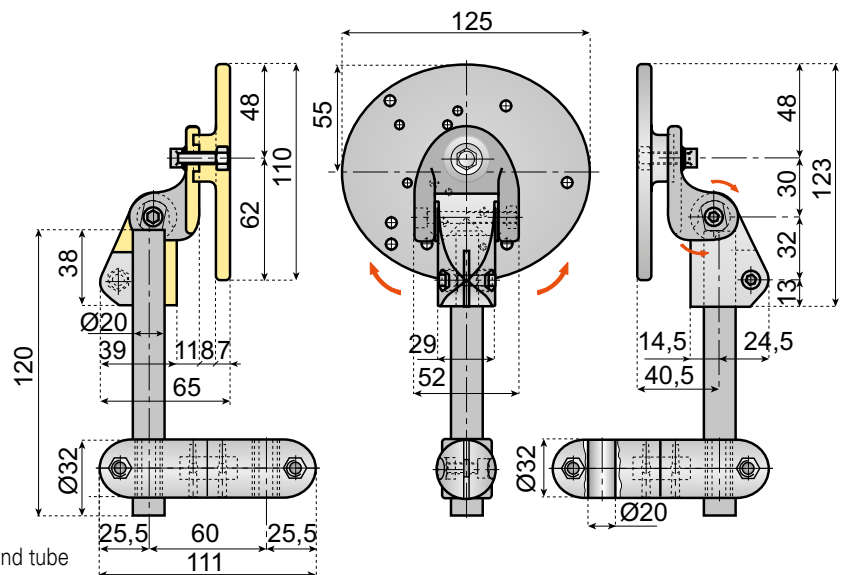

**Material:** cross clamp in reinforced polyamide, tightening bolt and tube in stainless steel.

**Supply:** assembled.

**Note:** max recommended tightening torque 2 Kgm.

FOR ROD DIAMETER		
Ø 20		
ITEM DESCRIPTION		
PC-KIT		50

Chains & sprockets	Wear strips	Side guide brackets & accessories	Levelers	Engineering manual
Modular belts & sprockets	Chain & belt return systems	Frame & structure supports	Bearing supports	
Curves & tracks	Side guide solutions	Miscellaneous products	Equipment	



## 5 3 6 4 5 a

## CROSS BLOCKS

[www.SystemPlastSmartGuide.com](http://www.SystemPlastSmartGuide.com)

**Material:** cross block in reinforced polyamide, bolts and nut in stainless steel, adjustable handles in reinforced polyamide with insert in nickel plated brass.

**Application:** for use in areas where frequent adjusting is required for vertical movement.

**Supply:** assembled.

**Note:** max recommended tightening torque 3 Kgm.

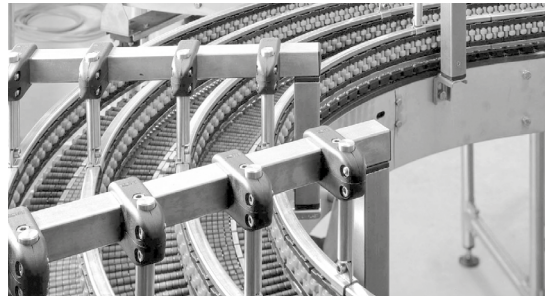

### TYPE STANDARD

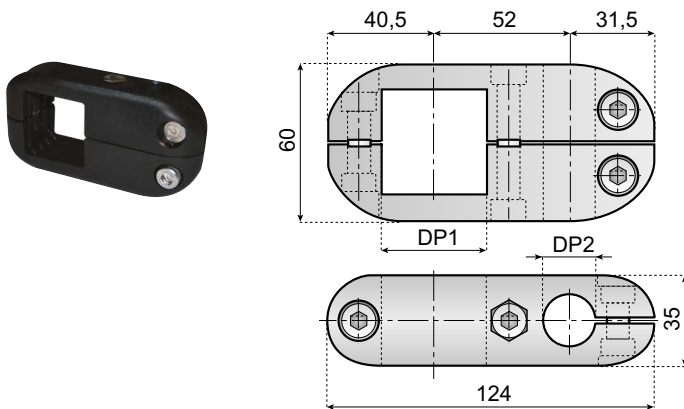

### TYPE V

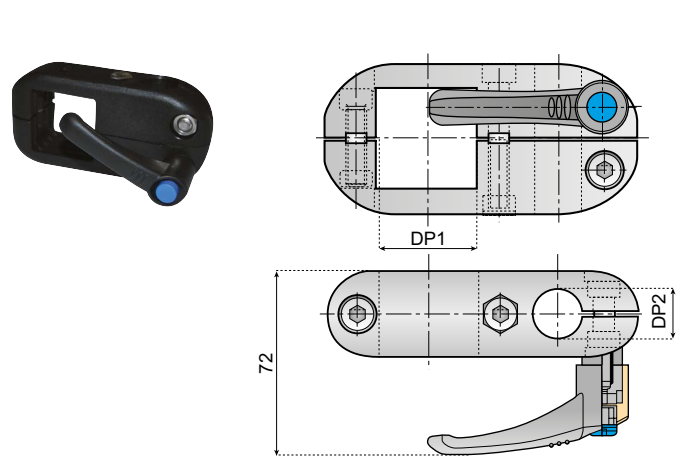

### TYPE HV

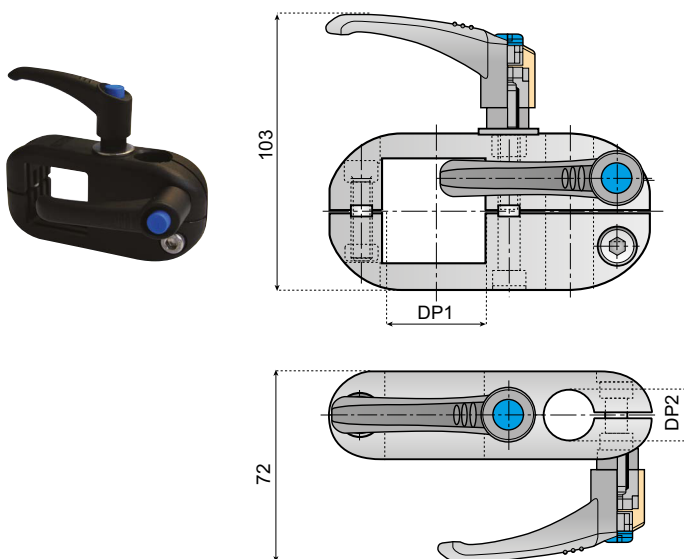

### TYPE H

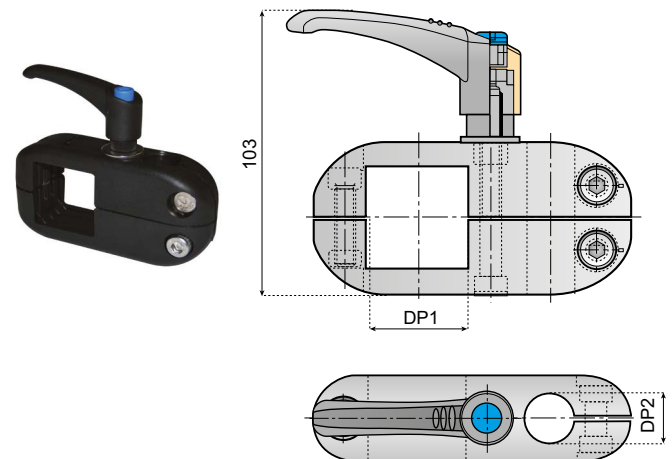

For other type of cross blocks, go to:

Also available for round bore DP1, go to:

## 5 3 6 5 0 a

## 5 3 6 5 0 a

DP 1	DP 2	TYPE STANDARD	TYPE V	TYPE HV	TYPE H	ITEM DESCRIPTION	50
		■ 40	● 16	CC-52-S40M-R16M	CC-52-S40M-R16MH		
■ 40	● 18 ■ 15	CC-52-S40M-R18M	CC-52-S40M-R18MH	CC-52-S40MH-R18MH	CC-52-S40MH-R18M		
■ 40	● 20	CC-52-S40M-R20M	CC-52-S40M-R20MH	CC-52-S40MH-R20MH	CC-52-S40MH-R20M		
■ 40	■ 20	CC-52-S40M-S20M	CC-52-S40M-S20MH	CC-52-S40MH-S20MH	CC-52-S40MH-S20M		

Chains & sprockets	Wear strips	<b>Side guide brackets &amp; accessories</b>	Levelers	Engineering manual
Modular belts & sprockets	Chain & belt return systems	Frame & structure supports	Bearing supports	
Curves & tracks	Side guide solutions	Miscellaneous products	Equipment	



## 5 3 6 5 0 a

## CROSS BLOCKS

[www.SystemPlastSmartGuide.com](http://www.SystemPlastSmartGuide.com)

**Material:** cross block in reinforced polyamide, bolts and nut in stainless steel, adjustable handles in reinforced polyamide with insert in nickel plated brass.

**Application:** for use in areas where frequent adjusting is required for vertical movement.

**Supply:** assembled.

**Note:** max recommended tightening torque 3 Kgm.

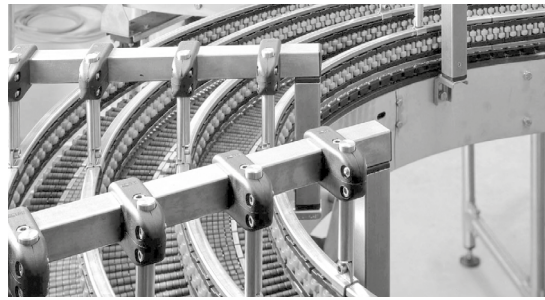

### TYPE STANDARD

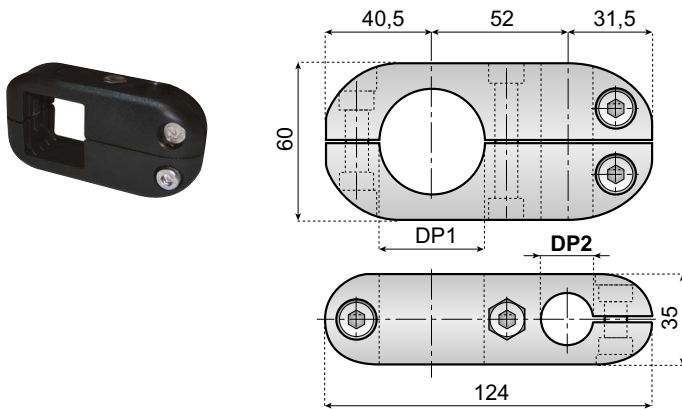

### TYPE V

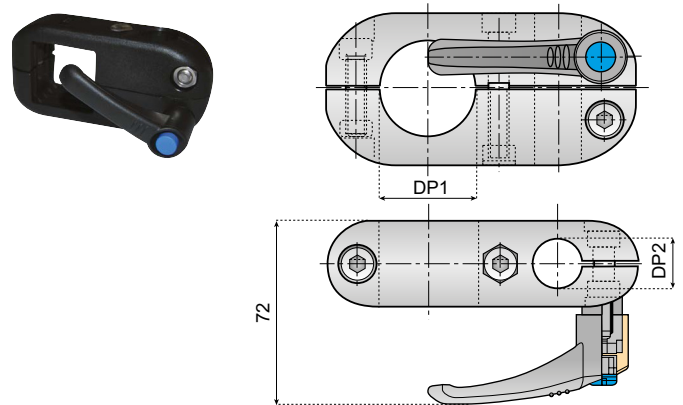

### TYPE HV

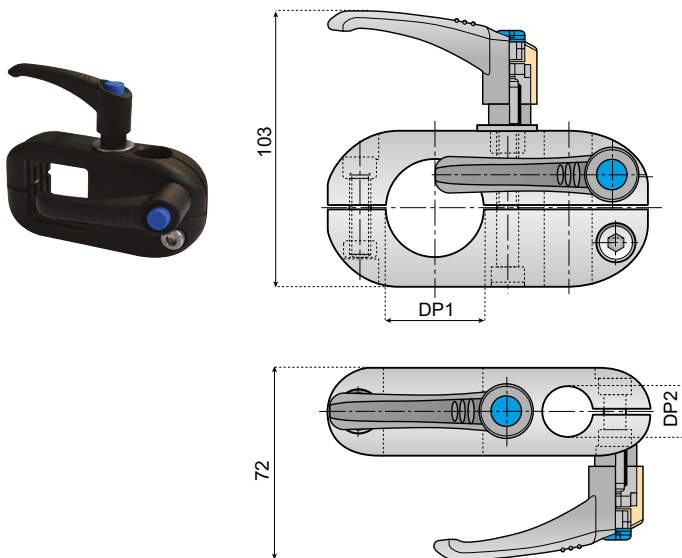

### TYPE H

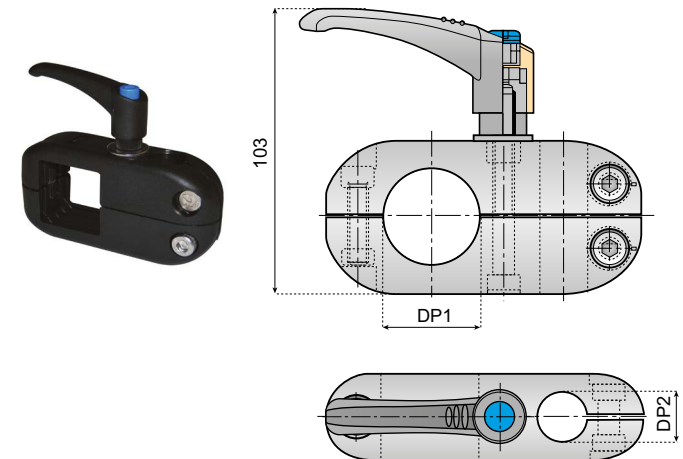

For other type of cross blocks go to:

## 5 3 6 4 5 a

DP 1	DP 2	TYPE STANDARD	TYPE V	TYPE HV	TYPE H	ITEM DESCRIPTION	50
		● 38.1	● 16	CC-52-R38M-R16M	CC-52-R38M-R16MH		
● 38.1	● 18 ■ 15	CC-52-R38M-R18M	CC-52-R38M-R18MH	CC-52-R38MH-R18MH	CC-52-R38MH-R18M		
● 38.1	■ 20	CC-52-R38M-S20M	CC-52-R38M-S20MH	CC-52-R38MH-S20MH	CC-52-R38MH-S20M		
● 38.1	● 20	CC-52-R38M-R20M	CC-52-R38M-R20MH	CC-52-R38MH-R20MH	CC-52-R38MH-R20M		
● 42.2	● 16	CC-52-R42M-R16M	CC-52-R42M-R16MH	CC-52-R42MH-R16MH	CC-52-R42MH-R16M		
● 42.2	● 18 ■ 15	CC-52-R42M-R18M	CC-52-R42M-R18MH	CC-52-R42MH-R18MH	CC-52-R42MH-R18M		
● 42.2	■ 20	CC-52-R42M-S20M	CC-52-R42M-S20MH	CC-52-R42MH-S20MH	CC-52-R42MH-S20M		
● 42.2	■ 20	CC-52-R42M-R20M	CC-52-R42M-R20MH	CC-52-R42MH-R20MH	CC-52-R42MH-R20M		